



# Notices and Schedules under the Bishop's Stortford Cemetery Act 2024 and Faculty 1903 in the Diocese of St Albans

March 2026

Explanatory note .....	2
Notice .....	4
Schedule of Affected Graves .....	5
Schedule of Names of persons whose remains it is proposed to disturb.....	6
Sorted by Grave Number .....	6
Sorted by recorded Last Name .....	30
Schedule of owners of Exclusive Rights of Burial that it is proposed be extinguished.....	55
Schedule of owners of Memorials that it is proposed be removed .....	55

## ***Explanatory note***

Under the Bishop's Stortford Cemetery Act 2024 and Faculty 1903 in the Diocese of St Albans the Council is granted the powers necessary to reuse graves for the purpose of providing additional space for burials. The powers are subject to certain conditions and protections for relatives of the deceased including a requirement to post specified notices. They supplement existing, more limited, powers of reuse which have utilised from 2017 to date.

Areas have been designated in the Old Cemetery in which it is proposed to reuse graves under these powers. These areas are the locations of the 'oldest' graves in the Cemetery, almost all dating back to before 1949 and many dating back to the 1800s. All graves within a designated area are potentially affected, with the exception of

- Graves where there is a recorded interment more recently than 31<sup>st</sup> December 1949
- Graves where the exclusive right of burial is owned by the Commonwealth Commission for War Graves
- Graves where a objection was received (and not withdrawn) during the passage of the Bishop's Stortford Cemetery Act 2024

Figure 1 below shows the areas designated for reuse. In this diagram the areas are as follows

- A – Area for coffin burials and cremated remains (consecrated)
- B – Area for coffin burials and cremated remains (un-consecrated)
- C – Area for the interment of cremated remains only (consecrated)
- D – Area for the interment of cremated remains only (un-consecrated)

In order to facilitate reuse it will be necessary, in areas A and B ONLY to

- Extinguish exclusive rights of burial
- Remove certain memorials
- Disturb human remains

These measures will not be necessary at the current time in areas C and D, where only cremated remains will be interred.

Exclusive rights of burial will be extinguished shortly after the expiry of the period of notice in the formal notice below.

Memorials removed may be reused or destroyed in accordance with the protocol which is published on the Council website, and on which both the Ministry of Justice and the Diocese of St Albans have been consulted. This protocol includes a requirement to consult on the historical significance of memorials and to refrain from removing memorials of special historical significance

Human remains disturbed will be re-interred in the same grave or elsewhere in the Cemetery, in accordance with the provisions of the Act. At the current time it is the intention to re-inter at a lower level in the same grave, a process known as 'lift and deepen', which is well known in church graveyards.

Memorials will be removed and human remains disturbed only shortly before a specific space is required for burial. The timing of this will depend on demand, but is likely to extend over a period of 20-40 years. Regulations for new memorials ensure that the character of the Cemetery is preserved or enhanced; the advice of the Conservation Officer was sought prior to the creation of these regulations.

The notice which follows this explanatory note is the formal notice required both under the Act and the Faculty. Questions or queries about this may be directed to [cemetery.admin@bishopsstortfordtc.gov.uk](mailto:cemetery.admin@bishopsstortfordtc.gov.uk)

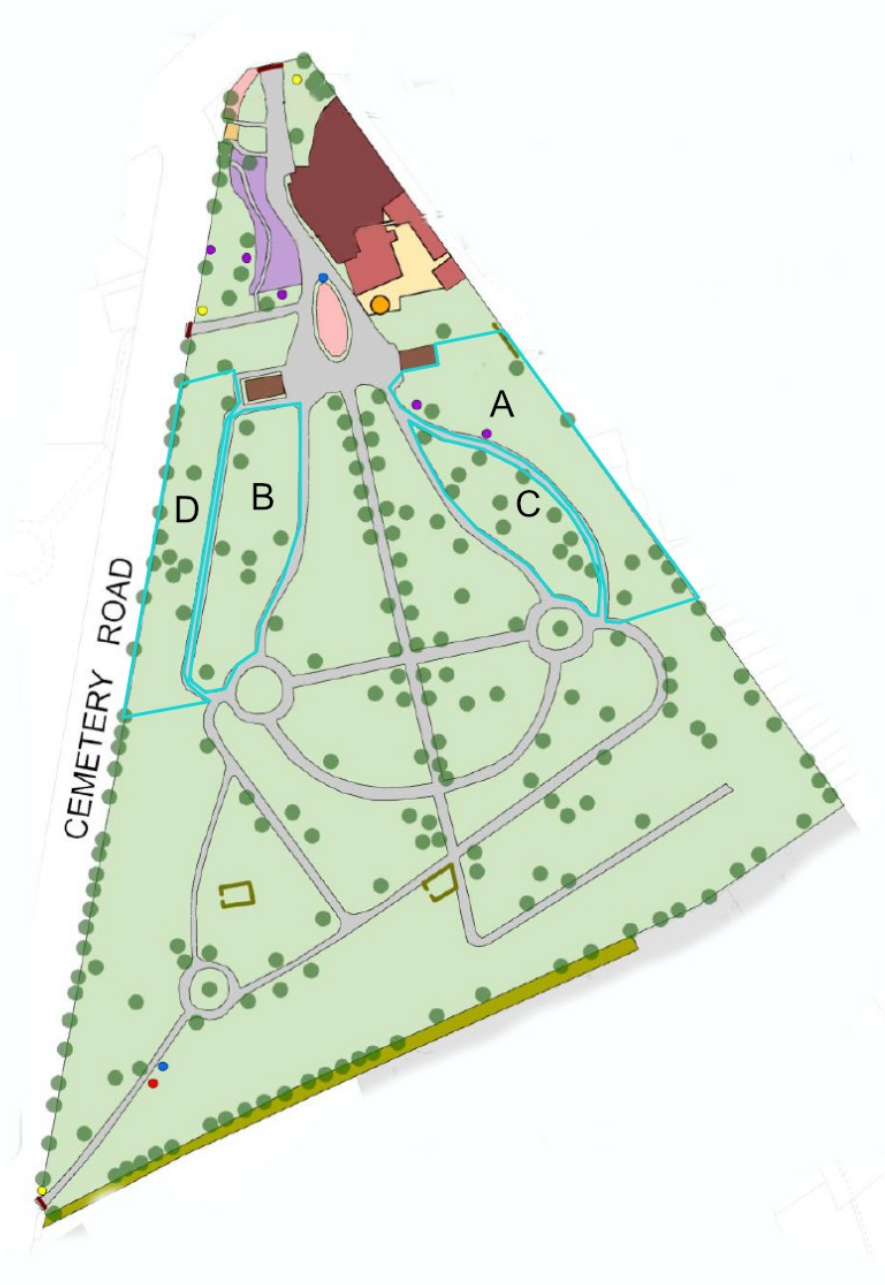

Figure 1 – Areas of Bishop's Stortford Old Cemetery designated for reuse (outlined in blue)

## ***Notice***

### **Bishop's Stortford Cemetery Act 2024 and Faculty 1903 in the Diocese of St Albans**

Bishop's Stortford Town Council hereby gives notice that it intends to extinguish exclusive rights of burial ('ERB'), remove memorials and disturb human remains in designated areas of the Old Cemetery, Bishop's Stortford. The purpose is to make space available for new burials. The graves affected are set out in the schedule below. Exclusive rights of burial will be extinguished on or soon after 15th October 2026. Memorials will be removed, and human remains disturbed when, or shortly before, the space in question is used for a new burial.

If a notice of objection in relation to any grave is made (and not withdrawn) by the registered owner of a an ERB or of a memorial, or by a relative of a person interred, no extinguishment of the ERB, removal of memorial or disturbance of human remains will take place in respect of that grave until 25 years has expired from the date of objection and further notices have been posted (in accordance with the Act) to which no objection is raised.

If a notice of objection to the extinguishment of an ERB in, or to the removal of a memorial from, any grave and of the grounds of any such objection is given by any other person, the right or memorial will not be extinguished/removed without the consent of the Secretary of State.

The registered owner may, within six months of the date on which an ERB is extinguished, make a claim for compensation, in which case Bishop's Stortford Town Council must pay compensation in accordance with the provisions of the Act, or, alternatively, revive the ERB.

Notices of objection must be given no later than 15th October 2026 to Bishop's Stortford Town Council, The Old Monastery, Windhill Bishop's Stortford, CM23 2ND FAO Chief Executive Officer, or by email to [cemetery.admin@bishopsstortfordtc.gov.uk](mailto:cemetery.admin@bishopsstortfordtc.gov.uk)

Further information, including the name (where known) of the registered owner of each ERB or memorial, and the names of any person whose remains it is proposed to disturb, appears in the schedules below.

## **Schedule of Affected Graves**

Graves for which it is proposed to disturb human remains, and (where applicable) extinguish exclusive rights of burial and/or remove or reuse memorials

**ALL** graves in sections EAST/B6, EAST/B7, EAST/C3, EAST/D2, EAST/D3, EAST/E3, EAST/F2, WEST/B2, WEST/B3, WEST/C5 **AND IN ADDITION** selected graves in the sections as set out below

<b>Section</b>	<b>Graves</b>
EAST/C4	All graves except grave number 17
EAST/C5	All graves except grave numbers 2a, 10
EAST/C6	All graves except grave numbers 21, 22, 23, 24, 25, 26
EAST/C7	All graves except grave numbers 12a, 14a, 16a, 21, 22E, 22W, 23, 24E, 24W, 25
EAST/D4	All graves except grave numbers 29, 30
EAST/E2	All graves except grave numbers 11, 24, 38, 43
EAST/F3	All graves except grave numbers 14, 14a, 15, 16
WEST/B4	All graves except grave numbers 17a, 21a, 24a, 30a
WEST/C3	All graves except grave numbers 4, 5a, 9a, 11a
WEST/C4	All graves except grave numbers 18a, 22a, 26a
WEST/C6	All graves except grave numbers 19a, 21
WEST/C7	All graves except grave numbers 1, 1a, 2, 2a, 3, 4, 5, 6, 7, 8, 9, 9a, 10, 11 All graves except grave numbers 1, 3E, 3W, 6, 7, 8a, 9, 10a, 11, 13, 13a,13b,15, 16bE, 16bW, 16c, 18a, 19
WEST/D5	
WEST/D6	All graves except grave number 2a
WEST/D7	All graves except grave numbers 19c, 19E, 20, 21
EAST/D5	Only grave numbers 1a, 2a, 3a, 4b, 6b, 9a, 10a, 14b, 18a
EAST/E4	Only grave numbers 1b, 3b, 5b, 7a, 21W, 26, 27, 27aE, 27aW, 29, 30
WEST/B5	Only grave numbers 1a, 2, 3a, 3b, 4, 4b, 5a, 6, 7a, 8, 8b, 10, 10a, 10b, 10c, 46a
WEST/C2	Only grave numbers 9b, 15a, 15b, 17a, 18a, 18b, 18c, 22, 25a, 26, 26b

## ***Schedule of Names of persons whose remains it is proposed to disturb***

The following table shows the names of persons whose remains it is proposed to disturb, sorted by grave number. A table sorted by last name follows.

Notes:

- the recorded name may not be the usual name by which the person was known, or the spelling may be different; it is therefore advised to check all variants.
- Interments of stillbirths are generally recorded as 'stillborn of <name>'
- Names of Infants may be preceded by 'Infant'

### **Sorted by Grave Number**

<b>Grave</b>	<b>Recorded Date of Interment</b>	<b>Recorded Name</b>
EAST/B6/2E	30/08/1880	Taylor, Infant_Ernest
EAST/B6/2W	27/08/1880	Turner, Infant_Herbert
EAST/B6/3	22/12/1877	Newman, William
EAST/B6/4E	06/03/1877	Turner, Infant_Esther
EAST/B6/4W	16/09/1862	Pateman, Infant_Sarah
EAST/B6/5E	09/10/1857	Thurgood, Stillborn_of
EAST/B6/5E	20/10/1884	Knight, Stillborn_of
EAST/B6/5W	06/10/1857	Hart, Infant_of
EAST/B6/6E	10/09/1857	Pateman, Infant_Mary_Ann
EAST/B6/6W	21/08/1857	Cowell, Infant_Selina
EAST/B6/6W	08/10/1883	Turner, Stillborn_of
EAST/B6/8E	05/06/1857	Dorrington, Stillborn_of_Mary
EAST/B6/8W	01/06/1857	Rumble, Stillborn_of_Mary
EAST/B6/9E	22/06/1859	Knight, Stillborn_of
EAST/B6/9W	05/04/1859	Brown, Infant_Charles
EAST/B6/9W	13/02/1904	Wood, Infant_Gwendoline
EAST/B6/10E	05/05/1857	Cox, Stillborn_male_of
EAST/B6/10W	27/12/1856	Candy, Infant_Elizabeth
EAST/B6/11E	23/12/1856	Hyde, Infant_Eliza_Jane
EAST/B6/11W	06/12/1856	Peachey, Stillborn_of
EAST/B6/12E	07/02/1857	Bond, Stillborn_of_Annie
EAST/B6/12W	20/12/1856	Chambers, Infant_William_H
EAST/B6/13E	13/09/1856	Rumble, Infant_Elizabeth_Ann
EAST/B6/13W	10/09/1856	Ellison, Infant_Mary_Isabella
EAST/B6/14	15/09/1856	Greata, William
EAST/B7/2E	02/01/1856	Harle, Stillborn_of
EAST/B7/2W	28/12/1855	Clark, Stillborn_of_Frederick
EAST/B7/3	26/11/1855	Coote, Infant_Lucy
EAST/B7/4W	23/08/1859	Patmore, Stillborn_of
EAST/B7/5	15/01/1856	Glasscock, James

<b>Grave</b>	<b>Recorded Date of Interment</b>	<b>Recorded Name</b>
EAST/B7/6	18/12/1855	Fish, Catherine
EAST/B7/7E	19/10/1860	Tyler, Stillborn_of
EAST/B7/7W	11/04/1856	Lambert, Infant_Ellen
EAST/B7/8	19/01/1856	Blackwell, James
EAST/B7/8	12/03/1888	Cass, Elizabeth
EAST/B7/9	04/01/1856	Fordham, Catherine
EAST/B7/10E	18/03/1856	Leech, Stillborn_of
EAST/B7/10W	20/02/1856	Uncle, Infant_Charles_W
EAST/B7/11	02/02/1856	Sapsford, Sarah
EAST/B7/12	08/01/1856	Uncle, Caroline
EAST/B7/13	23/02/1856	Champness, Mary
EAST/B7/14	11/02/1856	Shorter, William
EAST/B7/14	20/12/1884	Shorter, Susan
EAST/B7/15	08/03/1856	Archer, Emily
EAST/B7/15	05/03/1888	Archer, Martha
EAST/B7/16	29/11/1856	Rumball, Infant_Joseph
EAST/B7/16	19/03/1879	Marshall, Sarah
EAST/B7/17	13/02/1856	Lincoln, David
EAST/B7/18	14/05/1856	Nash, Millie
EAST/B7/19	13/12/1856	Archer, Thomas
EAST/B7/20E	16/02/1857	Finch, Stillborn_of
EAST/B7/20W	01/03/1856	Rumble, Infant_James
EAST/B7/21	21/03/1856	Waterman, Susan
EAST/B7/22	04/08/1856	Kinsie, Esther
EAST/B7/23	16/12/1856	Marshall, Thomas
EAST/B7/24E	07/02/1856	Tattingham, Infant_Ellen
EAST/B7/24W	08/01/1856	Castle, Stillborn_of_Walter
EAST/B7/25	06/05/1856	Howlett, Charles
EAST/B7/26	10/09/1856	Kent, William_S
EAST/B7/27E	04/04/1857	Lacey, Infant_female_of
EAST/B7/27W	11/02/1857	Shorter, Infant_Alfred
EAST/B7/28E	10/03/1856	Lambert, Infant_Sarah
EAST/B7/28W	20/02/1856	Collis, Infant_Ann
EAST/B7/29E	29/05/1856	Coxall, Infant_Emma
EAST/B7/29E	25/08/1856	Judd, Infant_Henry
EAST/B7/29W	29/05/1856	Coxall, Infant_Emma
EAST/B7/30E	12/11/1856	Lestrangle, Infant_Robert_J
EAST/B7/30W	12/11/1856	Dixon, Infant_Thomas
EAST/B7/31	17/02/1857	Lilley, Susannah
EAST/B7/32	13/03/1856	Prior, Daniel
EAST/B7/33	05/06/1856	Simons, Susan
EAST/B7/34	19/11/1856	Dunnage, George
EAST/B7/35	21/02/1857	Matthews, Elizabeth
EAST/C4/3	08/11/1880	Prior, Mary

<b>Grave</b>	<b>Recorded Date of Interment</b>	<b>Recorded Name</b>
EAST/C4/4	19/10/1878	Kitchener, Charlotte
EAST/C4/6	16/10/1878	Chapman, Sophia
EAST/C4/8W	18/02/1878	Knight, Stillborn_of_William
EAST/C4/10	01/05/1875	Knight, James
EAST/C4/13	01/03/1872	Orger, Martha
EAST/C4/14	25/10/1933	Threadgold, Charlotte
EAST/C4/15	20/02/1890	Thickings, Ann
EAST/C4/16	18/02/1868	Brace, James
EAST/C4/18	24/11/1877	Willis, James
EAST/C4/19	08/05/1857	Clarke, Richard
EAST/C5/2	27/01/1933	Fordham, Mabel_M
EAST/C5/2	23/03/1946	Fordham, Albert_J
EAST/C5/4	29/11/1862	Roberts, William
EAST/C5/5	16/09/1938	Fordham, Charlotte
EAST/C5/6	29/06/1932	Murrell, Edith_B
EAST/C5/6	14/04/1943	Sutton, Ellen
EAST/C5/7	07/03/1872	King, William
EAST/C5/8	16/12/1857	Barber, Mary
EAST/C5/8	07/04/1888	Ridgley, Mary
EAST/C5/9	28/03/1929	Pateman, Harriett_D
EAST/C5/9	05/07/1932	Pateman, Charles
EAST/C5/11	25/11/1862	Brace, Mary
EAST/C5/12	06/10/1863	Barber, James
EAST/C5/14E	10/11/1888	White, Infant_Alice_L
EAST/C5/14E	10/11/1888	Coe, Infant_Florence
EAST/C5/14W	16/12/1882	Fuller, Infant_William
EAST/C5/14W	28/02/1890	Reed, Infant_Mary_Ann
EAST/C5/14W	18/05/1899	Reed, Infant_Henry
EAST/C5/15	25/01/1859	Willis, Charles
EAST/C5/15a	21/06/1884	Fordham, James
EAST/C5/15a	05/01/1893	Fordham, Martha
EAST/C5/16W	03/01/1885	Fuller, Infant_John
EAST/C5/16W	27/02/1885	Turner, Stillborn_of
EAST/C5/17	12/12/1861	Bates, Mary
EAST/C5/18	11/02/1863	Coxall, Sarah
EAST/C5/18a	10/10/1885	Abrahams, Thomas
EAST/C5/19	20/10/1880	Brown, Mary
EAST/C5/20	28/10/1859	Stubbings, Sarah
EAST/C5/21a	21/06/1884	Westwood, William
EAST/C5/21a	21/06/1884	Robinson, Stillborn_of
EAST/C5/21E	14/04/1863	Morris, Infant_John
EAST/C5/21W	25/11/1882	Fuller, Infant_Alfred
EAST/C5/21W	09/12/1887	Fuller, Stillborn_of
EAST/C5/21W	09/02/1888	Fuller, Infant_of

<b>Grave</b>	<b>Recorded Date of Interment</b>	<b>Recorded Name</b>
EAST/C5/22	27/01/1862	Coxall, Ann
EAST/C5/23a	04/10/1888	Johnson, Sarah_Ann
EAST/C5/23W	08/10/1900	Reed, Infant_William_A
EAST/C5/24	10/06/1858	Coxall, Edward
EAST/C5/24a	07/09/1904	Threadgold, William
EAST/C5/25	12/12/1861	Goodson, Emily
EAST/C5/25a	01/03/1901	Fordham, Charlotte
EAST/C5/25a	04/09/1914	Fordham, James_W_J
EAST/C5/25b	10/09/1911	Turner, Infant_Charles
EAST/C5/26W	19/02/1866	Brown, Stillborn_of
EAST/C5/27	04/04/1860	Bradford, Thomas
EAST/C5/28	21/04/1866	Candy, Thomas
EAST/C5/29W	17/09/1864	Judd, Infant_Sarah_A
EAST/C5/30	01/03/1858	Flack, Maria
EAST/C5/30	08/10/1885	Turner, Martha
EAST/C5/31	09/11/1864	Candy, Richard
EAST/C5/32	10/11/1902	Turner, Charles
EAST/C6/1E	13/01/1858	Unknown, Infant_of
EAST/C6/1W	15/12/1857	Smith, Infant_Charles
EAST/C6/2a	13/08/1881	Turner, Mary_Ann
EAST/C6/2b	27/08/1904	Threadgold, Rebecca
EAST/C6/2b	12/09/1911	Threadgold, Zachariah
EAST/C6/2E	10/08/1860	Smith, Infant_Nathan
EAST/C6/2E	17/08/1886	Turner, Infant_Edward
EAST/C6/2W	26/03/1859	Fordham, Infant_Mary_Ann
EAST/C6/3E	13/01/1858	Cass, Stillborn_of
EAST/C6/3W	31/12/1857	Perry, Stillborn_of
EAST/C6/4	17/03/1858	Bradford, John
EAST/C6/4a	02/11/1881	Knight, Eliza
EAST/C6/5E	12/04/1858	Piper, Stillborn_of
EAST/C6/5W	15/01/1858	Knight, Infant_Emily_J
EAST/C6/6	06/04/1859	Prior, Ann
EAST/C6/6a	06/08/1881	Knight, Thomas
EAST/C6/6a	14/09/1892	Knight, Joshua
EAST/C6/7E	10/12/1857	Brooks, Infant_son_of_Mary
EAST/C6/7E	28/11/1887	Miller, Infant_Robert
EAST/C6/7W	05/12/1857	Carter, Infant_Sarah
EAST/C6/8	29/02/1860	Waterman, William
EAST/C6/8a	29/09/1904	Hutchins, Eliza
EAST/C6/9	26/12/1857	Yardley, Ann
EAST/C6/10	22/05/1860	Jeffreys, Jeffery
EAST/C6/11E	05/11/1857	Unknown, Stillborn_of
EAST/C6/11W	22/10/1857	Yardley, Infant_Mary_Ann
EAST/C6/12	11/07/1871	Smith, William

<b>Grave</b>	<b>Recorded Date of Interment</b>	<b>Recorded Name</b>
EAST/C6/12	05/02/1883	King, Stillborn_of
EAST/C6/12	05/02/1883	Smith, James
EAST/C6/12a	11/07/1907	Judd, Sarah
EAST/C6/13E	23/01/1858	Brown, Infant_Elizabeth
EAST/C6/13W	29/01/1858	Bush, Infant_Emily
EAST/C6/13W	04/02/1888	Ratcliff, Infant_Alfred
EAST/C6/14a	23/06/1909	Ayley, David
EAST/C6/14a	26/02/1915	Ayley, Anne
EAST/C6/14E	07/05/1862	Goats, Infant_Sarah
EAST/C6/14W	20/06/1863	Clauboy, Infant_William
EAST/C6/15	04/05/1857	Champness, Francis
EAST/C6/16	27/01/1863	Brown, John
EAST/C6/16a	19/05/1911	Thurley, Mary_Ann
EAST/C6/16a	14/03/1940	Thurley, Frederick_T
EAST/C6/17	09/09/1857	Wenham, Caleb
EAST/C6/18E	20/06/1862	Chambers, Infant_Henry
EAST/C6/18E	16/09/1887	White, Infant_Maud_D
EAST/C6/18W	23/01/1863	Champness, Infant_Emma
EAST/C6/19	22/05/1857	Carter, William
EAST/C6/20E	12/02/1863	Champness, Infant_Milicent
EAST/C6/20E	12/01/1888	Sampford, Infant_Rose
EAST/C6/20W	12/02/1863	Champness, Infant_Mary
EAST/C6/20W	08/09/1887	Stracey, Infant_Abraham
EAST/C6/27	10/12/1912	Lucking, Annie
EAST/C6/28	30/12/1947	Boyten, Infant_John_R
EAST/C7/1	24/07/1856	Wood, John
EAST/C7/2	19/01/1867	Turner, Elizabeth
EAST/C7/3	11/12/1856	Turner, Eliza
EAST/C7/4	13/03/1861	Turner, James
EAST/C7/5	26/06/1857	Newman, Mary
EAST/C7/6E	15/05/1863	Dorrington, Infant_Emma
EAST/C7/6W	02/05/1864	Edwards, Infant_Elizabeth
EAST/C7/6W	13/01/1888	Blake, Infant_Elizabeth
EAST/C7/7	08/06/1857	Watson, Sarah
EAST/C7/8	12/07/1862	Dorrington, James
EAST/C7/9	12/03/1858	Waterman, William
EAST/C7/10	09/02/1863	Kinsey, Ann
EAST/C7/11	09/01/1858	Waterman, Robert
EAST/C7/12E	12/07/1862	Archer, Infant_Elizabeth
EAST/C7/12W	30/01/1863	Rickett, Infant_Emily
EAST/C7/13	20/06/1857	Kinsey, George
EAST/C7/14	13/06/1862	Kinzie, Emma
EAST/C7/15E	09/07/1862	Fish, Infant_Henry
EAST/C7/15W	16/05/1862	Edwards, Infant_Eliza

<b>Grave</b>	<b>Recorded Date of Interment</b>	<b>Recorded Name</b>
EAST/C7/15W	07/02/1885	Fiske, Stillborn_of
EAST/C7/16	03/11/1869	Kinsey, Jeremiah
EAST/C7/17	21/02/1857	Matthews, Elizabeth
EAST/C7/17	26/03/1857	Matthews, James
EAST/C7/19	25/03/1857	Quinlan, Catherine
EAST/C7/20	15/12/1882	Kinsey, Mary_Ann
EAST/C7/20	07/05/1886	Kinsey, Emma
EAST/D2/1	16/08/1919	Thurgood, Mary_Ann
EAST/D2/1a	01/09/1931	Miller, Infant_Peter_J
EAST/D2/2a	06/08/1928	Brazier, Florence
EAST/D2/2W	06/11/1882	Webb, Infant_Esther
EAST/D2/2W	19/02/1887	Webb, Infant_George
EAST/D2/3	08/03/1895	Brown, John
EAST/D2/3a	02/07/1928	Sell, John_J
EAST/D2/4	29/07/1927	Piper, William
EAST/D2/4	13/12/1941	Piper, Sarah_A
EAST/D2/5W	09/05/1882	Loveday, Infant_Charles
EAST/D2/6	19/02/1923	Gilbey, Annie
EAST/D2/6a	07/03/1934	Stringer, Annie
EAST/D2/6a	28/09/1944	Stringer, James_R
EAST/D2/6c	18/04/1940	Piper, Mary_A
EAST/D2/7	01/05/1882	Ingram, George
EAST/D2/8	22/05/1923	Rumble, Annie
EAST/D2/8a	23/04/1931	Wilson, Infant_Edith_E
EAST/D2/9	20/01/1882	Fisher, Rachel
EAST/D2/10	05/05/1932	Francis, William
EAST/D2/11	09/07/1881	Heard, Dan
EAST/D2/12	12/10/1881	Clarke, John
EAST/D2/14	01/06/1881	Martin, Charles_H
EAST/D2/15E	23/02/1882	Thickings, Stillborn_of
EAST/D2/15E	31/08/1889	Pope, Infant_Alice_E
EAST/D2/15W	04/06/1881	Bayford, Infant_Martha
EAST/D2/16	31/01/1936	Brett, Mary_A
EAST/D2/16	04/02/1941	Brett, Amos
EAST/D2/17W	07/11/1891	Pope, Infant_Agnes_E
EAST/D2/18	14/04/1881	Bull, John
EAST/D2/19W	23/03/1888	Reed, Infant_Elsie_E
EAST/D2/20	27/07/1880	Matthews, Catherine_A
EAST/D2/21	21/08/1880	Newman, Thomas
EAST/D2/23E	13/03/1888	Gray, Infant_of
EAST/D2/23W	29/06/1888	Day, Infant_girl_of
EAST/D3/2W	24/10/1879	Archer, Stillborn_twins_of
EAST/D3/2W	31/10/1885	Reed, Infant_Elsie_M
EAST/D3/3	08/05/1880	Reed, Thomas

<b>Grave</b>	<b>Recorded Date of Interment</b>	<b>Recorded Name</b>
EAST/D3/4E	02/12/1892	Wilson, Infant_James
EAST/D3/6W	14/09/1892	Harrison, Infant_Lily
EAST/D3/7	25/10/1879	Read, Ann
EAST/D3/8	27/09/1878	Adams, Joseph
EAST/D3/9E	10/01/1877	Flack, Infant_John
EAST/D3/10	18/06/1874	Marshall, Nathaniel
EAST/D3/11	09/12/1874	Ginn, Edward
EAST/D3/12	04/08/1878	Bush, Ann
EAST/D3/14	21/02/1873	Bull, William
EAST/D3/15	02/06/1874	Savage, John
EAST/D3/16	17/02/1872	Matthews, Mary_Ann
EAST/D3/17	03/02/1873	Tinworth, George
EAST/D3/18	12/05/1874	Nicholls, William
EAST/D3/19W	19/06/1876	Unknown, Infant
EAST/D3/21	18/01/1872	Turner, Charlotte
EAST/D3/21	18/01/1872	Bush, Infant_William
EAST/D3/22E	31/05/1873	Privett, Stillborn_twins_of
EAST/D3/22W	29/03/1873	Player, Infant_Annie
EAST/D3/23	14/02/1874	Quilter, Benjamin
EAST/D3/24E	28/07/1875	Milton, Stillborn_twins_of
EAST/D3/24W	01/11/1875	Jugby, Infant_Thomas_A
EAST/D3/26	15/11/1871	Chapman, James
EAST/D3/27	30/01/1872	Snow, Allan
EAST/D3/28	24/01/1874	Quant, John
EAST/D3/29	20/03/1875	Judd, William
EAST/D3/30E	15/04/1874	Gray, Infant_David
EAST/D3/30W	16/10/1871	Turner, Infant_John
EAST/D3/31E	27/12/1871	Collins, Stillborn_of
EAST/D3/31W	20/12/1871	Payne, Infant_Gertrude_M
EAST/D3/32	14/12/1871	Bright, Mary
EAST/D3/33	10/07/1873	Brenchley, David
EAST/D3/34W	26/02/1875	Thurgood, Stillborn_(Wm)_of
EAST/D3/35	20/09/1871	Judd, John
EAST/D3/36	20/04/1871	Page, Edward
EAST/D3/37	01/12/1871	Moffart, Mary
EAST/D3/38E	19/09/1873	Archer, Stillborn_of
EAST/D3/38W	12/09/1873	Thurgood, Infant_Sarah
EAST/D3/39E	08/02/1875	Clark, Stillborn_twins_of
EAST/D3/39W	08/02/1875	Prior, Infant_Emily
EAST/D3/40	15/03/1871	Harding, John
EAST/D3/41	29/12/1870	Griggs, Charles
EAST/D3/42	27/11/1871	Kent, George
EAST/D3/43	19/12/1871	Biscoe, Samuel
EAST/D3/44	26/01/1875	Curtis, Ann

<b>Grave</b>	<b>Recorded Date of Interment</b>	<b>Recorded Name</b>
EAST/D4/1	23/12/1869	Banks, Joseph
EAST/D4/2	29/08/1870	Judd, Peter
EAST/D4/3	17/11/1871	Rand, William
EAST/D4/4	04/08/1869	Blackwell, Stephen
EAST/D4/5E	10/05/1870	Bowker, Infant_Arthur_V
EAST/D4/5W	03/09/1860	Bowker, Infant_Edward_W
EAST/D4/6	22/12/1869	Banks, Charlotte
EAST/D4/7	10/10/1870	Kitchener, William
EAST/D4/8	19/05/1871	Erswell, Ann
EAST/D4/9	19/10/1870	Prior, Charles
EAST/D4/10E	17/03/1877	Perry, Infant_Thomas_H
EAST/D4/10W	12/03/1877	Chapman, Infant_Eliza
EAST/D4/11	07/01/1872	Smith, Mary_Ann
EAST/D4/11	07/01/1872	Parker, Infant_Emily
EAST/D4/12	05/02/1867	Kitchener, Martha
EAST/D4/13	19/12/1870	Chapman, William
EAST/D4/14a	15/05/1882	Ballard, Sarah
EAST/D4/14a	23/05/1882	Ballard, Stillborn_of
EAST/D4/14E	01/04/1872	Walker, Infant_Walter_J
EAST/D4/14W	07/09/1867	Reed, Infant_James
EAST/D4/15	06/02/1861	Knight, William
EAST/D4/16	12/05/1866	Dench, Edward
EAST/D4/17a	02/07/1881	Kitchener, William
EAST/D4/17W	17/07/1869	Brown, Infant_Emily
EAST/D4/17W	06/02/1877	Champness, Stillborn_(Hg)_of
EAST/D4/18aE	12/08/1909	Monk, Infant_Dennis_W
EAST/D4/18aW	08/11/1909	Turner, Infant_Florence_D
EAST/D4/18E	03/10/1871	Pateman, Infant_Edith
EAST/D4/18W	31/12/1865	Knight, Infant_John
EAST/D4/19	02/11/1861	Dench, Joseph
EAST/D4/20	19/09/1868	Brown, Thomas
EAST/D4/20a	04/11/1881	Judd, Mary_Ann
EAST/D4/20a	04/01/1925	White, Infant_Joan_A_M
EAST/D4/20b	05/03/1911	Lucking, Infant_Mary
EAST/D4/21	12/10/1860	Shedd, Maria
EAST/D4/22	28/08/1866	Shed, John
EAST/D4/22a	20/05/1882	Waterworth, Thomas
EAST/D4/22b	26/03/1891	Blake, Daniel
EAST/D4/22b	12/07/1907	Blake, Caroline
EAST/D4/22b	16/06/1930	Rickett, Elizabeth
EAST/D4/23	19/04/1864	Rickett, William
EAST/D4/24a	12/03/1883	Parker, Hannah
EAST/D4/24b	09/11/1911	Seuell, Infant_William
EAST/D4/24E	18/06/1862	Kitchener, Infant_Martha

<b>Grave</b>	<b>Recorded Date of Interment</b>	<b>Recorded Name</b>
EAST/D4/24W	05/03/1862	Kitchener, Infant_William
EAST/D4/25	10/01/1859	Ricketts, Sarah
EAST/D4/26	05/01/1866	Rickett, Ellen
EAST/D4/26a	13/03/1885	Rickett, Jaems
EAST/D4/27a	03/11/1882	Newman, Philip
EAST/D4/27b	22/10/1910	White, Infant_Charles_E
EAST/D4/27E	01/04/1863	Prior, Infant_Fanny
EAST/D4/27W	02/02/1869	Crabb, Infant_Martha
EAST/D4/28	10/04/1858	Saltmarsh, Samuel
EAST/D4/28a	01/11/1883	Saltmarsh, Charlotte
EAST/D4/31E	21/06/1909	Trott, Infant_Edith_M
EAST/D5/1a	21/02/1882	Harris, William
EAST/D5/1a	05/03/1905	Harris, Elizabeth
EAST/D5/2a	07/08/1884	Newman, William
EAST/D5/2a	28/02/1900	Newman, Alfred
EAST/D5/3a	18/11/1902	Newman, John
EAST/D5/4b	26/10/1912	Bugg, William
EAST/D5/6b	14/06/1947	Perkins, Infant_Thomas_C
EAST/D5/9a	04/03/1947	Barton, Infant_Leonard
EAST/D5/10a	20/11/1914	Compton, Sarah
EAST/D5/10a	15/06/1925	Prior, Ann
EAST/D5/14b	09/10/1947	Jarvis, Infant_Rita
EAST/D5/18a	16/06/1947	Walker, Infant_Robert
EAST/E2/1W	30/09/1884	Webb, Infant_Hester
EAST/E2/1W	14/08/1885	Sapsford, Infant_Alice
EAST/E2/2	26/03/1884	Champness, Elizabeth
EAST/E2/4	04/08/1916	Payne, Infant_Charles
EAST/E2/5	12/04/1883	Downes, Samuel
EAST/E2/6	08/09/1883	Barrow, Charles
EAST/E2/6	17/11/1883	Ashton, Stillborn_of
EAST/E2/7	19/01/1892	Gilbey, George
EAST/E2/8	29/12/1915	Francis, Elizabeth
EAST/E2/9	13/10/1882	Guiver, William
EAST/E2/10	10/03/1883	Shaw, Elizabeth
EAST/E2/12	06/12/1915	Woodley, Eliza
EAST/E2/13	13/09/1882	Griffen, Mary
EAST/E2/14	01/12/1882	Collins, Charles_J
EAST/E2/15	29/06/1891	Shead, Mary
EAST/E2/16	05/12/1915	Saddler, Elizabeth
EAST/E2/17	20/05/1882	Cass, Charles
EAST/E2/18E	03/06/1882	Eaton, Infant_Elizabeth
EAST/E2/18E	28/03/1883	Palmer, Stillborn_of
EAST/E2/18W	22/12/1888	Webb, Infant_Charles
EAST/E2/19	24/05/1890	Tyler, William

<b>Grave</b>	<b>Recorded Date of Interment</b>	<b>Recorded Name</b>
EAST/E2/20	25/09/1915	Keeler, Infant_Herbert_J
EAST/E2/21	30/01/1882	Ansell, James
EAST/E2/22	09/12/1881	Rumble, William
EAST/E2/24a	10/10/1931	Bonney, Infant_Jack_A
EAST/E2/25E	04/09/1880	Robinson, Stillborn_of
EAST/E2/25E	09/02/1882	Reed, Stillborn_of
EAST/E2/25W	29/06/1881	Warner, Stillborn_of
EAST/E2/25W	31/07/1882	Handscomb, Stillborn_of
EAST/E2/26E	01/06/1881	Seamark, Infant_Emily
EAST/E2/26E	28/04/1882	Flack, Stillborn_of
EAST/E2/26W	01/06/1881	Manning, Stillborn_of
EAST/E2/26W	20/08/1887	Sapsford, Infant_William
EAST/E2/27	18/08/1887	Sapsford, Alice
EAST/E2/28	27/02/1915	Barron, Harriet
EAST/E2/28a	30/03/1915	Harmsworth, Charles
EAST/E2/29E	22/07/1880	Hills, Infant_Martha
EAST/E2/29W	20/05/1880	Fitch, Infant_James
EAST/E2/29W	09/07/1880	Bush, Infant_Ellen
EAST/E2/30	27/01/1881	Francis, Thomas
EAST/E2/31	13/11/1886	Morton, Samuel
EAST/E2/32	19/07/1912	Parker, Eliza
EAST/E2/33	20/03/1915	Willey, Alice
EAST/E2/34	15/05/1880	Perry, Harriet
EAST/E2/36E	10/06/1885	Miller, Infant_Margaret
EAST/E2/36E	30/07/1885	Osborne, Infant_of
EAST/E2/36W	16/01/1881	Hills, Infant_Eliza_E
EAST/E2/37E	09/02/1898	Warwick, Infant_Archibald
EAST/E2/39	09/02/1880	Smith, Jane
EAST/E2/41E	20/07/1882	King, Infant_Elizabeth
EAST/E2/41E	04/09/1882	Turner, Stillborn_of
EAST/E2/41E	10/12/1883	King, Infant_William
EAST/E2/42	25/11/1887	Brown, Ann
EAST/E3/1	29/12/1879	Howard, Winifred
EAST/E3/2	13/01/1879	Felsted, Jane
EAST/E3/3W	06/09/1878	Willie, Infant_Belinda_J_L
EAST/E3/3W	23/03/1888	Player, Infant_Florence_M
EAST/E3/4	14/07/1877	Brown, Thomas
EAST/E3/5	19/04/1871	Freeman, John
EAST/E3/6	23/08/1879	Matthews, David
EAST/E3/7	29/08/1878	Birch, Rebecca
EAST/E3/8	19/03/1879	Searle, Michael
EAST/E3/9	15/03/1878	Wheeler, John
EAST/E3/10	14/08/1868	Freeman, Ann
EAST/E3/11	02/07/1877	Tipler, Susan

<b>Grave</b>	<b>Recorded Date of Interment</b>	<b>Recorded Name</b>
EAST/E3/12W	27/02/1883	Turner, Stillborn_of
EAST/E3/13	07/12/1878	Webb, Ann
EAST/E3/14E	13/10/1879	Halestrap, Stillborn_of_S
EAST/E3/14W	19/06/1878	Soole, Infant_Walter
EAST/E3/14W	07/05/1879	Sewell, Infant_Ellen
EAST/E3/15	03/12/1875	Poole, Emma
EAST/E3/16	10/07/1876	Warwick, John
EAST/E3/17	27/12/1876	Fleury, Elizabeth
EAST/E3/18	13/07/1878	Carter, Alfred
EAST/E3/19E	13/12/1880	Griggs, Infant_Thomas_H
EAST/E3/19E	19/06/1882	Almond, Infant_Walter
EAST/E3/19E	08/07/1882	Joscelyne, Stillborn_of
EAST/E3/19W	05/04/1880	Sewell, Stillborn_of
EAST/E3/20	18/12/1875	Keane, Ann
EAST/E3/21	06/04/1876	Hennifer, Richard
EAST/E3/22	23/06/1876	Pope, John
EAST/E3/23E	09/12/1878	Read, Infant_George
EAST/E3/23W	07/02/1877	Miles, Infant_Mary_Ann
EAST/E3/23W	28/02/1887	Miles, Infant_Bertie_T
EAST/E3/24E	24/11/1880	Rumble, Infant_George
EAST/E3/24W	22/12/1880	Crabb, Infant_Emma_E
EAST/E3/24W	03/09/1886	Haines, Infant_William_C
EAST/E3/25	24/10/1879	Parker, John
EAST/E3/26	03/03/1876	Shedd, Henry
EAST/E3/27	22/05/1876	Lilley, Sarah
EAST/E3/28	02/06/1874	Sapsford, Cornelius
EAST/E3/29	18/10/1879	Dyson, Harriet
EAST/E3/30	18/01/1879	Tyler, Hannah
EAST/E3/31	23/02/1876	Tyler, Elizabeth
EAST/E3/32	27/11/1875	Gilbey, Stephen
EAST/E3/33	15/03/1873	White, Thomas
EAST/E3/34	14/01/1881	Sapsford, Mary
EAST/E3/34a	21/10/1881	Tyler, Joseph
EAST/E3/35	12/04/1875	Jackson, Mary_Ann
EAST/E3/36	04/09/1873	Pope, William
EAST/E3/37	29/06/1869	Perry, Mary
EAST/E3/37	06/01/1883	Perry, George
EAST/E3/37a	17/09/1886	Chapman, Ann
EAST/E3/37b	01/07/1887	Blatch, Thomas
EAST/E3/38	18/12/1875	Smith, Mary
EAST/E3/39	04/09/1877	Bowker, John_B
EAST/E3/39a	25/10/1890	Hammond, John
EAST/E3/39b	04/02/1907	Judd, Peter
EAST/E3/40	11/01/1875	Gates, George

<b>Grave</b>	<b>Recorded Date of Interment</b>	<b>Recorded Name</b>
EAST/E3/41	24/03/1884	Lilley, John
EAST/E3/42	24/08/1912	Marshall, William
EAST/E4/1b	29/10/1927	Wellow, Infant_Grace_L
EAST/E4/3b	25/01/1912	Smith, James
EAST/E4/5b	10/01/1935	Cook, Susan_F
EAST/E4/7a	15/04/1885	Gilbey, Thomas
EAST/E4/7a	26/10/1896	Gilbey, Emma
EAST/E4/21W	12/06/1865	Dellow, Infant_Kate
EAST/E4/26	19/06/1882	Pope, Louisa
EAST/E4/27	15/09/1885	Whitehead, Eliza
EAST/E4/27aE	05/05/1909	Reed, Infant_William
EAST/E4/27aW	21/04/1909	Turner, Infant_Violet_I
EAST/E4/29	21/04/1906	Gates, Caroline
EAST/E4/30	08/09/1907	Castle, Susanna
EAST/F2/1	26/07/1913	Woodfall, Eliza
EAST/F2/1	15/10/1914	Lawrence, Emily
EAST/F2/1a	01/07/1915	Hawkes, Thomas
EAST/F2/2	09/06/1921	Harrington, Arthur_H
EAST/F2/2a	17/10/1893	Halls, William
EAST/F2/3	17/02/1881	Lawrence, George
EAST/F2/3a	24/04/1906	Harrington, William_H
EAST/F2/3a	30/08/1907	Harrington, Mary_Ann
EAST/F2/4	26/03/1858	Bates, William
EAST/F2/4a	07/12/1898	Brazier, Robert
EAST/F2/4a	04/03/1905	Brazier, Emma_L
EAST/F2/4b	15/06/1905	Handscomb, Violet_M
EAST/F2/4b	21/01/1914	Reed, Infant_Florence_M
EAST/F2/4c	09/05/1949	Finch, Infant_Michael
EAST/F2/5	17/02/1915	Clark, Harriet
EAST/F2/6	23/02/1915	Snowden, Infant_Robert_C
EAST/F2/7	25/04/1928	Osborne, Infant_Kenneth
EAST/F2/8a	21/08/1917	Handscomb, Albert
EAST/F2/8a	15/03/1929	Handscomb, Mary_Ann
EAST/F2/8E	28/08/1913	Savage, Infant_Winifred_M
EAST/F2/8W	19/10/1901	Brazier, Infant_Constance_A
EAST/F2/9	24/02/1915	Reed, Emma
EAST/F2/9	16/07/1930	Reed, William
EAST/F2/10	09/09/1876	Cook, Sarah_M
EAST/F2/11W	13/10/1880	Cooke, Infant_Harriet_R
EAST/F2/13E	03/11/1913	Green, Infant_Frederick_J
EAST/F2/13W	23/11/1909	Spencer, Infant_John_H_T
EAST/F3/1	31/07/1868	Soole, John
EAST/F3/2E	12/10/1870	Coote, Infant_John
EAST/F3/2W	11/08/1868	Coote, Infant_Thomas_J

<b>Grave</b>	<b>Recorded Date of Interment</b>	<b>Recorded Name</b>
EAST/F3/3a	15/05/1908	Patrick, Elizabeth_L
EAST/F3/3b	23/10/1913	Reed, Infant_Ephraim_L
EAST/F3/3E	28/02/1872	Coote, Infant_Florence_E
EAST/F3/3W	27/11/1875	Coote, Infant_Alice
EAST/F3/4	27/04/1864	Soole, Charlotte
EAST/F3/5	08/10/1859	Burder, William_W
EAST/F3/6	06/09/1922	Knott, Emma
EAST/F3/6b	19/04/1915	Dutnall, Infant_Robert_V
EAST/F3/7	09/04/1860	Soole, Samuel
EAST/F3/8a	30/06/1922	Adam, Constance_N
EAST/F3/8E	10/08/1863	Newman, Infant_William
EAST/F3/8W	02/02/1861	Newman, Infant_Henry
EAST/F3/9W	31/12/1863	Miller, Stillborn_of
EAST/F3/10a	21/03/1925	Brazier, Arthur_R
EAST/F3/10a	10/07/1947	Brazier, Elizabeth
EAST/F3/10E	30/06/1885	Britton, Stillborn_Edward
EAST/F3/11E	24/10/1884	Reed, Infant_Matilda
EAST/F3/11E	24/12/1884	Carter, Stillborn_of
EAST/F3/11W	02/01/1885	Sewell, Infant_George
EAST/F3/12a	19/03/1923	Warwick, Infant_Arthur_W
EAST/F3/12E	05/08/1885	Mitchell, Infant_Emma_M
EAST/F3/13a	09/09/1949	Living, Infant_Paul_D
EAST/F3/13E	28/02/1885	Tattingham, Infant_Emma
EAST/F3/13W	07/02/1885	Mumford, Infant_Edwin_J
EAST/F3/14b	11/12/1925	Oliver, Infant_Annie_D
EAST/F3/15a	20/12/1921	Kitchener, Infant_Thomas_G
EAST/F3/16a	25/10/1927	Drake, Infant_Elizabeth_A
EAST/F3/17E	12/11/1908	Smith, Infant_Fred
EAST/F3/18b	02/10/1923	Thurley, Infant_Reginald_J
EAST/F3/18b	15/02/1923	Deller, Infant_Cecil_C
EAST/F3/18E	06/02/1909	Langdon, Infant_Esther_E
EAST/F3/18W	15/05/1909	Keeler, Infant_Frederick_J
EAST/F3/22b	17/07/1917	Fanner, Infant_Florence_M
EAST/F3/26a	20/06/1917	Thurgood, Infant_Robert_J
WEST/B2/1	09/04/1914	Pickess, Sarah
WEST/B2/1	27/02/1918	Pickess, Jabez
WEST/B2/2	27/11/1914	Shepherd, Alice_E
WEST/B2/3	18/11/1874	Parker, Mary_Ann
WEST/B2/3	04/08/1931	Thresher, Infant_Kenneth_B
WEST/B2/4	12/04/1914	Mitchell, George
WEST/B2/4	18/04/1933	Mitchell, Mary_A
WEST/B2/5	15/12/1915	Peacock, Maria
WEST/B2/6E	07/01/1879	Thurgood, Stillborn_of
WEST/B2/6W	05/03/1873	Thurgood, Infant_Clara_H

<b>Grave</b>	<b>Recorded Date of Interment</b>	<b>Recorded Name</b>
WEST/B2/7	10/10/1870	Tucker, Sophia
WEST/B2/7	10/10/1870	Tucker, Stillborn_of_Sophia
WEST/B2/7	02/10/1945	Parker, Harriet
WEST/B2/8	02/07/1873	Portway, William
WEST/B2/9	09/10/1860	Dixon, Joseph
WEST/B2/10E	25/08/1866	Green, Infant_Henry
WEST/B2/10W	26/04/1867	Thurgood, Infant_Mercy
WEST/B2/11E	08/07/1872	Thurgood, Stillborn_of_John
WEST/B2/11W	26/02/1868	Tucker, Infant_Alfred_W
WEST/B2/12	10/10/1872	Harvey, Infant_Frederick_E
WEST/B2/13	08/05/1916	Atkin, Richard
WEST/B2/14	16/03/1918	Chappell, William
WEST/B2/15	14/05/1940	Porter, Infant_Percy
WEST/B3/1a	18/04/1928	Atkin, Rebecca
WEST/B3/1E	17/12/1858	Parker, Stillborn_of
WEST/B3/1W	21/08/1858	Cracknell, Infant_Edward
WEST/B3/2E	11/06/1859	Parker, Infant_Elizabeth
WEST/B3/2W	08/04/1859	Thurgood, Infant_James
WEST/B3/3E	30/05/1863	Parker, Infant_Robert
WEST/B3/3W	08/04/1867	Tucker, Infant_Alfred_W
WEST/B3/4W	15/04/1862	Harvey, Infant_Ernest_John
WEST/B3/5	10/07/1860	Tharby, Henry
WEST/B3/5a	12/02/1925	Bushwell-Wye, Infant_Irene_D
WEST/B3/6	27/08/1862	Dalton, Charles
WEST/B3/7	01/07/1863	Parker, Robert
WEST/B3/7	25/07/1928	Parker, George
WEST/B3/8	01/04/1867	Parker, Robert
WEST/B3/8	16/09/1892	Parker, Sophia
WEST/B3/9	10/06/1859	Tharby, Malachia
WEST/B3/9a	01/09/1926	Livermore, Infant_Horace_E
WEST/B3/10	02/02/1861	Whitby, Mary
WEST/B3/10	20/01/1864	Whitby, Joseph
WEST/B3/11E	04/03/1864	Newman, Infant_Edward_T
WEST/B3/11W	30/05/1863	Watson, Infant_Emma
WEST/B3/12	15/12/1881	Portway, Peter
WEST/B3/12	02/05/1903	Portway, Sarah
WEST/B3/13	24/07/1863	Newman, Elizabeth
WEST/B3/13a	02/09/1926	Taylor, Infant_Cyril
WEST/B3/14	29/07/1862	Chappell, Samuel
WEST/B3/15E	15/01/1868	Sapsford, Infant_Willie_D
WEST/B3/15W	15/06/1869	Chappell, Infant_Frederick_J
WEST/B3/16	01/11/1865	Miller, Mary_Ann
WEST/B3/17	30/06/1858	Newman, William
WEST/B3/17a	02/12/1927	Edwards, Infant_Charles

<b>Grave</b>	<b>Recorded Date of Interment</b>	<b>Recorded Name</b>
WEST/B3/18	25/12/1858	Prior, Benjamin
WEST/B3/19	03/10/1863	Prior, Thomas
WEST/B3/20E	04/09/1872	Sapsford, Infant_Percy_J
WEST/B3/20W	24/07/1876	Sapsford, Stillborn_of_George
WEST/B3/21	16/01/1858	Thurgood, Mary
WEST/B3/21a	14/03/1932	Jackson, Infant_William_D
WEST/B3/22	03/09/1860	Potter, Joseph
WEST/B3/23E	14/03/1862	Potter, Infant_Eliza_Emily
WEST/B3/23W	22/05/1962	Thurgood, Infant_Elizabeth_A
WEST/B3/24	05/09/1860	Gould, James
WEST/B3/24a	10/04/1886	Nicholls, Eliza
WEST/B3/24b	08/01/1939	Smith, Infant_Michael_C
WEST/B3/25	16/10/1860	Scarfe, Infant_Herbert_J
WEST/B3/26	13/09/1870	Sapsford, James
WEST/B3/26	30/10/1878	Sapsford, Sarah
WEST/B3/27	04/12/1867	Rickett, Elizabeth
WEST/B3/27a	19/09/1891	Gibbs, Elizabeth
WEST/B3/27a	27/12/1902	Cornell, Ann
WEST/B3/28	02/10/1865	Cornwell, William
WEST/B3/28	06/02/1885	Cornwell, Ann
WEST/B3/29	28/07/1863	Woodcock, Ann
WEST/B3/30	06/08/1867	Yardley, William
WEST/B3/30a	13/05/1892	Potter, Sarah
WEST/B3/30a	27/09/1902	Potter, William
WEST/B3/31	05/10/1861	Lankester, Mary_B
WEST/B3/32	12/09/1863	Phipp, Thomas
WEST/B3/33	20/07/1864	Ricketts, John
WEST/B3/34	24/11/1865	Newman, William
WEST/B3/34a	29/11/1915	Newman, Thomas
WEST/B3/34a	20/11/1928	Newman, Mary_Ann
WEST/B3/36	31/05/1860	Rickett, Maria
WEST/B4/1	11/01/1866	Newman, Emma
WEST/B4/1a	18/01/1916	Haynes, Infant_Mabel
WEST/B4/2	26/07/1860	Phipp, Caroline
WEST/B4/3	26/01/1861	Glasscock, Sarah
WEST/B4/4	20/11/1868	Newman, John
WEST/B4/4a	23/09/1939	Dorman, Infant_Jean
WEST/B4/5	16/03/1861	Smith, Elizabeth
WEST/B4/6	21/02/1862	Glasscock, James
WEST/B4/6b	21/10/1944	Ash, Infant_Peter
WEST/B4/7	09/06/1885	Clark, Elizabeth
WEST/B4/7a	02/03/1941	Lovell, Infant_David_S
WEST/B4/7b	28/02/1941	Warwick, Infant_Ernest_G
WEST/B4/8	21/09/1859	Smith, Charles

<b>Grave</b>	<b>Recorded Date of Interment</b>	<b>Recorded Name</b>
WEST/B4/8	18/02/1888	Archer, Mary_Ann
WEST/B4/9	23/01/1863	Bush, Sarah
WEST/B4/10	23/01/1863	Clark, John_C
WEST/B4/10a	09/06/1920	Pomphrett, Infant_kathleen_I
WEST/B4/11	23/02/1859	Salmon, Nathaniel
WEST/B4/12	13/06/1860	Kelly, Elizabeth
WEST/B4/13	29/11/1859	Knight, Sarah
WEST/B4/13a	02/07/1931	Newman, Infant_Pauline_D
WEST/B4/14	05/04/1860	Salmon, Robert
WEST/B4/14a	08/01/1944	Wilkins, Infant_Linda_A
WEST/B4/15	31/03/1863	Bull, Sarah_A
WEST/B4/15a	18/09/1916	Newman, William
WEST/B4/15a	30/03/1935	Newman, Margaret
WEST/B4/15b	30/12/1919	Curtis, Infant_Leonard_W
WEST/B4/16	02/03/1861	Salmon, Henry
WEST/B4/17	20/10/1862	Prance, Sarah
WEST/B4/18a	29/07/1938	Simpson, Infant_John_A
WEST/B4/18E	27/07/1887	Scherzinger, Infant_George_L_W_L
WEST/B4/18W	11/05/1861	Salmon, Infant_Eliza
WEST/B4/19	11/04/1864	Thurgood, Sarah
WEST/B4/20	29/09/1877	Hughes, James
WEST/B4/20	28/04/1880	Hughes, Emily
WEST/B4/20a	03/04/1922	Newman, Walter
WEST/B4/21	24/05/1861	Sherman, Sarah_D
WEST/B4/22	22/09/1876	Cornwell, Penelope
WEST/B4/22a	10/02/1925	Lobb, Infant_Daisy
WEST/B4/22a	10/12/1925	Lobb, Infant_Violet
WEST/B4/23a	27/07/1939	Wigley, Infant_Margaret_C
WEST/B4/23E	07/03/1862	Pryer, Infant_Thomas
WEST/B4/23W	19/03/1861	Myson, Infant_John
WEST/B4/24	01/01/1910	Parish, John
WEST/B4/24	17/07/1913	Parish, Rachel
WEST/B4/25E	20/09/1861	Peacock, Infant_William_J
WEST/B4/25W	27/06/1863	Feltham, Infant_Frederick_Francis
WEST/B4/26a	04/01/1918	Mott, Louisa
WEST/B5/1a	23/04/1910	Carter, Amy
WEST/B5/1a	21/10/1944	Carter, Joseph
WEST/B5/2	13/02/1861	Peacock, Samuel
WEST/B5/3a	06/04/1910	Francis, Caroline
WEST/B5/3b	21/12/1933	Ayliffe, Infant_Kathleen
WEST/B5/3b	14/11/1942	Benbow, Infant_Frederick_E
WEST/B5/4	05/01/1889	Peacock, Anne
WEST/B5/4b	22/02/1916	Sewell, Infant_Annie
WEST/B5/5a	16/08/1912	Archer, Fanny

<b>Grave</b>	<b>Recorded Date of Interment</b>	<b>Recorded Name</b>
WEST/B5/5a	28/04/1938	Cook, Infant_Arthur_J
WEST/B5/6	30/12/1859	Death, Gideon
WEST/B5/7a	07/10/1948	Ashwell, Infant_Penelope_J
WEST/B5/8b	26/10/1918	Hollidge, Kate_V
WEST/B5/10	10/04/1867	Lock, Infant_Thomas_B
WEST/B5/10	21/12/1867	Lock, Infant_Amelia_E
WEST/B5/10	14/07/1875	Lock, Catherine_M
WEST/B5/10a	03/10/1927	Martin, Lizzie
WEST/B5/10a	24/07/1931	Martin, Edward
WEST/B5/10b	05/03/1909	Martin, Charles
WEST/B5/10b	19/09/1924	Martin, Eliza
WEST/B5/10c	26/02/1913	Dawling, Harriet
WEST/B5/10c	03/04/1933	Reed, Infant_Norma_P
WEST/B5/46a	08/01/1944	Russo, Infant_Keith_R
WEST/C2/9b	18/01/1933	Hughes, Clara
WEST/C2/9b	12/09/1944	Hughes, Frank_M
WEST/C2/15a	18/08/1924	Thurley, Lydia_E
WEST/C2/15b	31/10/1932	Monk, Infant_Carol_M
WEST/C2/17a	28/10/1924	Sullivan, Ada
WEST/C2/18a	13/06/1922	Jubb, Joseph_G
WEST/C2/18b	13/06/1927	Clark, Infant_Albert_C
WEST/C2/18c	27/01/1932	Clark, Infant_Doris
WEST/C2/22	11/06/1937	Harvey, Emma_G
WEST/C2/25a	30/11/1925	Lavell, Infant_Frederick_H
WEST/C2/26	28/05/1880	Portway, Charles
WEST/C2/26	06/12/1902	Ellis, Sarah_K
WEST/C2/26	03/02/1909	Postway, Sarah
WEST/C2/26b	16/02/1925	Webb, Infant_Dorothy_M
WEST/C3/1	23/11/1889	Harvey, James_H
WEST/C3/1	11/02/1900	Harvey, James
WEST/C3/1	03/05/1902	Harvey, Emma
WEST/C3/1a	31/01/1917	Drage, Sarah_A
WEST/C3/2a	24/02/1925	Everett, Jane
WEST/C3/2a	11/10/1926	Fordham, Rosetta
WEST/C3/2a	07/04/1927	Nutter, Margaret_M
WEST/C3/2a	17/02/1941	Everett, Emma
WEST/C3/3	13/11/1871	Watson, Ruth
WEST/C3/4a	02/04/1928	Everett, George
WEST/C3/5E	20/09/1870	Watson, Infant_George
WEST/C3/5W	12/04/1879	Bacon, Infant_Florence_E
WEST/C3/6	14/07/1875	Watson, Mary_Ann
WEST/C3/7a	04/06/1931	Hutchin, Minnie
WEST/C3/8E	05/09/1870	Miller, Infant_Herbert_W
WEST/C3/8E	20/06/1874	Miller, Infant_Ellen_E

<b>Grave</b>	<b>Recorded Date of Interment</b>	<b>Recorded Name</b>
WEST/C3/8W	16/08/1894	Ellis, Infant_Roland_F
WEST/C3/9	31/07/1875	Miller, Samuel
WEST/C3/9b	08/05/1933	Martin, William
WEST/C3/9b	02/04/1947	Martin, Sarah
WEST/C3/10	13/01/1875	Miller, Ann
WEST/C3/11E	02/02/1874	Chappell, Infant_Flora_D
WEST/C3/11W	11/05/1876	Green, Infant_Ann
WEST/C3/11x	17/09/1931	Pearman, Minnie
WEST/C3/12E	12/09/1873	Newman, Infant_Rose_A
WEST/C3/12W	06/12/1878	Newman, Infant_Annie
WEST/C3/13E	09/07/1871	Chappell, Infant_Kate_A
WEST/C3/13W	04/09/1877	Miller, Infant_Beatrice_A
WEST/C3/14	10/11/1869	Newman, Jeffery
WEST/C3/15a	03/10/1939	Sapsford, Mary_M
WEST/C3/15a	03/04/1948	Sapsford, William
WEST/C3/15b	22/08/1949	Mole, Infant_Pamela_A
WEST/C3/15E	13/04/1872	Chappell, Stillborn_of
WEST/C3/15W	23/09/1875	Chappell, Infant_Albert
WEST/C3/16E	14/12/1866	Fuller, Infant_William
WEST/C3/16W	21/06/1870	Phipp, Infant_Alfred_H
WEST/C3/17E	16/09/1873	Phipp, Infant_Thomas_H
WEST/C3/17W	07/12/1874	Chapple, Infant_Edith
WEST/C3/18	12/05/1911	Thorne, John
WEST/C3/18a	07/09/1930	Bent, Infant_Michael_R
WEST/C3/19	09/11/1866	Yardley, Anne
WEST/C3/20	02/04/1872	Thickings, Sarah_A
WEST/C3/21	16/03/1878	West, Sarah
WEST/C3/21a	15/05/1929	Walker, Infant_William_C
WEST/C3/22W	21/01/1867	Faircloth, Infant_Louisa_A
WEST/C3/22W	21/03/1870	Prior, Infant_Alfred
WEST/C3/23	05/05/1876	Prior, Joseph
WEST/C3/24	14/12/1877	Tharby, Esther
WEST/C3/24a	18/10/1928	Parker, Sarah_E
WEST/C3/24a	24/10/1944	Parker, Walter_G
WEST/C4/1E	13/10/1864	Cracknell, Stillborn_of
WEST/C4/1W	25/02/1859	Brooks, Infant_Elizabeth
WEST/C4/2	20/04/1872	Yardley, Hannah
WEST/C4/3	22/10/1877	Thurgood, Susan
WEST/C4/4	21/12/1866	Salmon, Matilda
WEST/C4/4	26/08/1908	Salmon, William
WEST/C4/5	01/03/1873	Rickett, George
WEST/C4/6	27/04/1877	Yardley, Amy
WEST/C4/6a	26/10/1914	Hopwood, John
WEST/C4/7E	26/03/1877	Phipp, Infant_John_W

<b>Grave</b>	<b>Recorded Date of Interment</b>	<b>Recorded Name</b>
WEST/C4/7W	02/12/1862	Cracknell, Infant_Joseph
WEST/C4/8	06/12/1869	Mears, Hannah
WEST/C4/9	25/11/1874	Gould, Samuel
WEST/C4/10	02/04/1909	Handsombe, John
WEST/C4/10a	04/07/1926	Clayden, Infant_Dorothy_J
WEST/C4/11	21/05/1863	Hales, Benjamin
WEST/C4/12	06/06/1870	Boyton, Henry
WEST/C4/13	28/05/1873	Gould, Mary
WEST/C4/14	28/07/1904	Salmon, Henry
WEST/C4/14a	01/08/1924	Clayden, Infant_Ernest
WEST/C4/15	30/04/1864	Boyton, Milly
WEST/C4/16	15/12/1866	Boyton, John
WEST/C4/17	18/01/1875	Cracknell, Frederick_G
WEST/C4/18E	05/04/1882	Filby, Infant_Agnes_M
WEST/C4/18W	19/05/1898	Waterman, Infant_Robert_W
WEST/C4/19	17/11/1868	Clark, James
WEST/C4/20	13/05/1871	Boyton, John
WEST/C4/21E	13/09/1871	Hendry, Infant_Norman_W
WEST/C4/21W	17/02/1877	Chopping, Bessie
WEST/C4/22E	25/03/1880	Salmon, Infant_Benjamin
WEST/C4/23	10/02/1864	Ingold, John
WEST/C4/24	08/02/1867	Jackson, Sarah
WEST/C4/25	04/06/1870	Barrance, John
WEST/C4/27	28/11/1868	Thurgood, Ephraim
WEST/C4/28E	05/06/1869	Ingold, Stillborn_of
WEST/C4/28W	30/06/1871	Waterman, Infant_Frederick
WEST/C4/29	22/03/1867	Barrance, Rebecca
WEST/C4/30	27/05/1875	Hibbard, John
WEST/C4/31	06/06/1882	Whitby, Daniel
WEST/C4/32	29/05/1866	Clayton, Jane
WEST/C4/33	07/11/1873	Barker, Emily
WEST/C4/34	06/05/1873	Bradd, Mary
WEST/C4/35	11/09/1873	Bradd, Helen_A
WEST/C4/36	23/06/1881	Tisoe, Ann_I
WEST/C4/37E	06/06/1863	Portway, Stillborn_of
WEST/C4/37W	19/01/1867	Gull, Infant_Martha
WEST/C4/38	26/03/1864	Tunnicliff, Eliza
WEST/C4/39E	05/01/1870	Adcock, Infant_Mary
WEST/C4/39W	23/12/1876	Chopping, Infant_Pamela
WEST/C4/40	06/12/1875	Clayden, James
WEST/C4/41	28/06/1865	Careless, Infant_Joseph
WEST/C4/41	28/06/1865	Careless, Infant_Jane
WEST/C5/1E	01/09/1863	Peacock, Infant_Mary_E
WEST/C5/1W	21/08/1868	Gull, Infant_Susannah

<b>Grave</b>	<b>Recorded Date of Interment</b>	<b>Recorded Name</b>
WEST/C5/2	03/02/1869	Gull, George
WEST/C5/3	01/01/1875	Waterman, Lydia
WEST/C5/4	02/11/1874	Challis, Hannah_M
WEST/C5/5E	19/01/1876	Challis, Infant_Frank_M
WEST/C5/5W	25/02/1870	Careless, Infant_Sarah_Elizabeth
WEST/C5/5W	17/04/1929	Gregory, Mary_A
WEST/C5/6E	21/03/1870	Peacock, Stillborn_of
WEST/C5/6W	23/06/1869	Pavitt, Infant_Matilda_E
WEST/C5/7	21/08/1866	Saggs, George
WEST/C5/8	02/05/1871	Whitby, Charles
WEST/C5/9	30/05/1873	Challis, James
WEST/C5/10	24/07/1880	Brooks, Margaret
WEST/C5/11	11/07/1871	Burls, Joseph
WEST/C5/12	05/07/1867	White, James
WEST/C5/13	25/03/1872	Handscombe, Rebecca
WEST/C5/14	19/01/1875	Challis, James
WEST/C5/15	26/05/1876	Boyton, Emma
WEST/C5/16	20/09/1870	Burls, Stephen_J_R
WEST/C5/17	05/01/1867	White, Mary_Ann
WEST/C5/18E	09/06/1875	Phillips, Infant_Mary_Ann
WEST/C5/18W	01/12/1871	Handscombe, Infant_Charles
WEST/C5/19	27/10/1873	Clarke, James
WEST/C5/20	12/11/1879	Waterman, David
WEST/C5/21E	19/06/1893	Hollidge, Infant_Nellie_C
WEST/C5/21W	01/06/1870	Lilley, Infant_Arthur_S
WEST/C5/22	25/07/1870	White, Henry
WEST/C5/23E	14/09/1871	Chopping, Infant_Stanton_G
WEST/C5/23W	14/03/1867	Handscomb, Infant_Martha
WEST/C5/24	01/03/1878	Waterman, Lydia_A
WEST/C5/25	23/12/1878	Waterman, George
WEST/C5/26E	27/04/1893	Hollidge, Infant_Fred_M
WEST/C5/26W	24/06/1863	Paxman, Infant_Hyrum
WEST/C5/27	02/03/1872	White, Lizzie
WEST/C5/28	27/10/1877	Searle, Alfred
WEST/C5/28	26/10/1900	Searle, Sarah
WEST/C5/29	02/03/1875	Salmon, Thomas
WEST/C5/30	13/03/1866	Piper, Israel
WEST/C5/31	14/06/1882	Hollidge, Charlotte
WEST/C5/31	22/02/1884	Martin, Elizabeth
WEST/C5/32	06/01/1879	Perkin, Alice
WEST/C5/33E	14/09/1878	Chopping, Infant_Percy_R
WEST/C5/33E	14/09/1878	Moyes, Stillborn_of
WEST/C5/33W	29/08/1878	Handscombe, Infant_Eliza
WEST/C5/34	20/02/1880	Handscomb, William

<b>Grave</b>	<b>Recorded Date of Interment</b>	<b>Recorded Name</b>
WEST/C5/34	20/12/1884	Handsombe, Infant_Fanny
WEST/C5/35E	12/08/1869	Merritt, Infant_John
WEST/C5/35W	24/04/1869	Piper, Infant_Walter
WEST/C5/36	09/04/1889	Uncle, Harriet
WEST/C5/37E	31/08/1877	Prior, Stillborn_of_Fred
WEST/C5/37W	29/08/1876	Perkins, Infant_Emma
WEST/C5/38W	31/01/1865	Bull, Infant_Henry
WEST/C5/39E	22/10/1884	Thornton, Infant_Amy
WEST/C5/39W	03/03/1881	Handscomb, Infant_Harriet
WEST/C5/40	07/08/1871	Burton, Sarah
WEST/C5/41	08/01/1890	Ingold, Sarah
WEST/C5/42	16/08/1862	Beard, Infant_Walter_N
WEST/C5/42	21/11/1883	Beard, Ellen
WEST/C5/43W	21/12/1866	Bull, Infant_Henry
WEST/C5/45	02/12/1880	Akers, Alfred
WEST/C5/46	02/03/1891	Brooks, Annie
WEST/C5/46	25/07/1894	Brooks, Thomas
WEST/C5/47	16/08/1878	Beard, John
WEST/C5/47	30/08/1889	Beard, Susanna
WEST/C5/48	30/12/1871	Bull, John
WEST/C5/49	17/12/1879	Bull, George
WEST/C5/50E	21/02/1873	Prior, Infant_Richard
WEST/C5/50W	09/03/1875	Baker, Infant_William_J_P
WEST/C6/1	03/12/1878	Nind, Elizabeth
WEST/C6/1a	03/06/1899	Ingold, George
WEST/C6/1a	29/07/1911	Ingold, Ann
WEST/C6/2	07/09/1872	Bull, Mary_E
WEST/C6/3	21/02/1876	Burrell, Thomas
WEST/C6/4a	12/12/1887	Beard, Aun
WEST/C6/4a	15/08/1917	Beard, Benjamin
WEST/C6/4b	09/08/1944	Belsham, Infant_Rosemary_R
WEST/C6/4E	19/07/1872	Prior, Infant_George
WEST/C6/4W	25/01/1870	Burrell, Infant_Ann_Elizabeth
WEST/C6/5	24/01/1903	Parkin, Emma
WEST/C6/5	16/03/1912	Parkin, William
WEST/C6/6E	25/04/1879	Bush, Infant_Sydney
WEST/C6/6W	24/09/1878	Bardwell, Infant_John
WEST/C6/7a	14/07/1919	Fuller, Wallis_R
WEST/C6/7E	02/03/1876	Bardell, Infant_of_William
WEST/C6/7W	12/07/1875	Gull, Infant_Nathan
WEST/C6/8W	08/08/1864	Barker, Infant_Alfred_J
WEST/C6/9E	12/07/1881	Prior, Infant_Frank
WEST/C6/9W	28/01/1880	Prior, Infant_Frederick
WEST/C6/10E	03/03/1877	Bush, Infant_John

<b>Grave</b>	<b>Recorded Date of Interment</b>	<b>Recorded Name</b>
WEST/C6/10W	25/09/1876	Pateman, Infant_George
WEST/C6/11	17/06/1913	Parkin, Samuel
WEST/C6/11a	15/04/1944	Hopson, Infant_Samuel
WEST/C6/12	16/02/1880	Prior, Agnes_L
WEST/C6/13	14/11/1877	Turner, Lucy
WEST/C6/13a	20/07/1917	Fuller, Bertie_T
WEST/C6/14W	30/08/1880	Lilley, Infant_William_J
WEST/C6/14W	06/01/1882	Lilly, Infant_Ernest
WEST/C6/15a	14/12/1918	Kelly, Beatrice_E
WEST/C6/15E	16/04/1880	Neville, Infant_Edward_W
WEST/C6/15W	10/11/1879	Bass, Infant_Henry_G
WEST/C6/16W	29/04/1882	Neville, Infant_Ada_M
WEST/C6/17a	19/02/1913	Hoare, Celiah
WEST/C6/17b	21/11/1906	Fitch, Elizabeth
WEST/C6/17b	03/05/1915	Fitch, Robert
WEST/C6/17E	11/08/1884	Clayden, Infant_William_H
WEST/C6/17W	25/08/1880	Chopping, Infant_Walter
WEST/C6/18	27/10/1881	Boyten, Ann
WEST/C6/18a	03/01/1906	Amey, Mary_Ann
WEST/C6/18a	11/10/1922	Amey, William
WEST/C6/18b	02/02/1910	Pateman, James
WEST/C6/18b	18/12/1920	Pateman, Sarah
WEST/C6/19	06/05/1893	Bayford, Mary_Ann
WEST/C6/19b	11/09/1912	Lilley, Margaret
WEST/C6/19b	30/08/1922	Lilley, James
WEST/C6/20	02/10/1891	Cracknell, George
WEST/C6/20	02/04/1922	Cracknell, Harriet
WEST/C6/20b	17/06/1940	Bonney, Infant_June
WEST/C6/22	26/06/1885	Dellow, David
WEST/C6/22a	06/12/1915	Knight, Arthur
WEST/C6/22a	14/12/1940	Knight, Emily_A
WEST/C6/27E	26/04/1880	Hutchin, Infant_George
WEST/C7/1b	28/11/1884	Cannon, Milly
WEST/C7/2b	24/02/1912	Shorter, Arthur
WEST/C7/2c	18/06/1923	Grant, Infant_George
WEST/C7/4a	19/06/1940	Prime, Infant_Geoffrey_H
WEST/C7/6a	17/01/1938	Smith, Infant_Pamela_P
WEST/C7/9b	08/03/1940	Boyten, Infant_Kenneth
WEST/C7/12	21/08/1918	Baillie, Elizabeth
WEST/C7/13	24/12/1926	Hicks, Walter_J
WEST/C7/14	25/01/1929	Robinson, Amelia
WEST/C7/21	28/11/1884	Cannon, Milly
WEST/C7/24	31/08/1918	Roberts, Florence_A
WEST/C7/24	21/12/1929	Perry, Mary_A

<b>Grave</b>	<b>Recorded Date of Interment</b>	<b>Recorded Name</b>
WEST/D5/2E	18/04/1861	Griggs, Infant_Arthur_W
WEST/D5/3a	25/07/1947	Mitchell, Infant_John
WEST/D5/4E	22/05/1857	Griggs, Infant_of_
WEST/D5/5W	08/04/1861	Griggs, Infant_Herbert_J
WEST/D5/6a	16/11/1885	Boyten, William
WEST/D5/7b	30/01/1911	Newman, Emma
WEST/D5/8	06/01/1882	Pigram, Margaret
WEST/D5/8	27/04/1918	Pigram, Elizabeth
WEST/D5/10	15/06/1885	Whitby, Honor
WEST/D5/12	04/05/1881	Salmon, Harriett
WEST/D5/12a	04/07/1928	Brewster, John
WEST/D5/12a	28/03/1930	Brewster, Martha
WEST/D5/14	21/10/1876	Prior, Elizabeth
WEST/D5/14a	15/09/1923	Prior, Mary
WEST/D5/14a	16/07/1930	Prior, Walter
WEST/D5/16	26/12/1874	Woodcock, Sarah
WEST/D5/17	13/02/1874	White, Susan
WEST/D5/18	23/01/1891	Phipp, Henry
WEST/D5/18	27/01/1891	Phipp, Susan
WEST/D5/44	07/06/1875	Player, Sarah
WEST/D6/1	23/11/1881	Woodcock, James
WEST/D6/2	13/11/1886	Cowell, Eliza_A
WEST/D6/3	21/08/1877	Milton, John
WEST/D6/4a	31/12/1930	Knight, Eliza
WEST/D6/4b	28/02/1925	Free, George
WEST/D6/4W	19/06/1882	Pateman, Infant_William_J
WEST/D6/5	29/06/1875	Billings, Thomas
WEST/D6/6	16/04/1888	Pateman, Esther
WEST/D6/6	08/05/1888	Hart, Stillborn_of
WEST/D6/6a	02/05/1927	Saich, Emma
WEST/D6/6a	13/04/1927	Saich, Henry
WEST/D6/7	31/10/1873	Barron, Hannah
WEST/D6/8	09/10/1872	Blackaby, Joseph
WEST/D6/8	19/10/1889	Blackaby, Sarah
WEST/D6/9	23/06/1884	Pateman, William
WEST/D6/10E	01/10/1872	Say, Stillborn_of_John
WEST/D6/10W	30/01/1871	Say, Stillborn_of
WEST/D6/11	05/05/1915	Lambert, Henry_E
WEST/D6/11	24/06/1943	Lambert, Florence_J
WEST/D6/12	23/07/1887	Piper, Charles
WEST/D6/13W	21/01/1870	Say, Infant_Joseph_G
WEST/D6/14	12/02/1895	Say, Rebecca
WEST/D6/14	10/05/1899	Say, John
WEST/D6/15	20/12/1876	Harris, John

<b>Grave</b>	<b>Recorded Date of Interment</b>	<b>Recorded Name</b>
WEST/D6/16	22/02/1876	Say, Eleanor_G
WEST/D6/17a	19/02/1904	Hutchin, Maria
WEST/D6/17E	15/12/1888	Pound, Infant_Ethel
WEST/D6/17W	05/05/1863	Spooner, Infant_Sydney_H
WEST/D6/18	26/01/1887	Dunnage, Annie_L
WEST/D6/19	05/11/1884	Hutchin, Elizabeth
WEST/D6/20	21/10/1890	Gray, Emma
WEST/D6/20aE	07/04/1894	Green, Infant_Eleanor
WEST/D6/20aW	10/03/1894	Green, Infant_Edith_J
WEST/D6/20aW	04/01/1903	Green, Infant_Doris_A
WEST/D6/21	20/06/1883	Prior, Richard
WEST/D6/22E	09/05/1884	Saich, Infant_Henry_J
WEST/D6/22E	09/05/1884	Tattingham, Stillborn_of
WEST/D6/22W	15/09/1880	Hutchin, Infant_Mary_Ann
WEST/D6/23	24/10/1877	Grey, John
WEST/D6/25	15/12/1880	Gillett, Linda
WEST/D6/26	08/06/1875	Gillett, William
WEST/D6/27E	26/04/1880	Hutchin, Infant_George
WEST/D6/27W	03/04/1879	Saich, Stillborn_of
WEST/D6/28	29/01/1898	Gillett, Elizabeth
WEST/D6/28	13/06/1901	Gillett, Edmund
WEST/D7/1E	06/04/1881	Cannon, Infant_Emma
WEST/D7/1E	30/01/1884	Cannon, Infant_Annie_M
WEST/D7/1W	06/04/1881	Cannon, Infant_Emma
WEST/D7/2	13/10/1883	Hauchett, Elizabeth
WEST/D7/3	01/07/1874	Nash, Elizabeth
WEST/D7/4	22/02/1898	Wilson, Susannah
WEST/D7/4a	06/11/1915	Green, Alfred
WEST/D7/5E	02/07/1879	Linsell, Stillborn_of
WEST/D7/5W	11/06/1879	Cannon, Infant_Eleanor
WEST/D7/6	19/04/1875	Hanchett, Thomas
WEST/D7/7	11/11/1874	Gull, Ruth
WEST/D7/8a	12/05/1904	Green, Mary
WEST/D7/8E	01/08/1876	Livermore, Stillborn_of_William
WEST/D7/8W	14/04/1877	Livermore, Stillborn_of_William
WEST/D7/9E	02/12/1910	Crisp, Infant_Bertram
WEST/D7/9W	09/06/1883	Cannon, Infant_Minnie
WEST/D7/10E	08/11/1878	Lawrence, Stillborn_of
WEST/D7/10W	02/06/1876	Livermore, Infant_Daniel
WEST/D7/11	28/10/1874	Livermore, Elizabeth
WEST/D7/12	20/08/1868	Threadgold, Zachariah
WEST/D7/12a	07/01/1893	Bull, Mary
WEST/D7/12a	21/09/1898	Livermore, Daniel
WEST/D7/13a	09/05/1925	Crisp, Infant_Kathleen_M

<b>Grave</b>	<b>Recorded Date of Interment</b>	<b>Recorded Name</b>
WEST/D7/13b	10/12/1927	Fuller, William_J
WEST/D7/13b	13/07/1940	Fuller, Sarah
WEST/D7/13E	30/04/1912	Firman, Infant_Cyril
WEST/D7/13W	17/11/1881	Livermore, Stillborn_of
WEST/D7/14	15/01/1886	Gull, Hannah
WEST/D7/15	19/10/1887	Livermore, Mary_Ann
WEST/D7/15	21/12/1925	Livermore, Thomas
WEST/D7/15a	07/07/1893	Pateman, Joseph
WEST/D7/16aW	20/08/1912	Livermore, Infant_Charles
WEST/D7/16W	08/12/1885	Livermore, Infant_Charles
WEST/D7/17a	10/08/1921	Green, Annie
WEST/D7/17E	04/02/1863	Bowfell, Infant_Sarah_A
WEST/D7/18	16/08/1892	Gull, Sarah_E
WEST/D7/18a	25/04/1925	Jackson, William
WEST/D7/18a	24/02/1928	Jackson, Emily_H
WEST/D7/18bE	27/02/1909	Skinner, Infant_Eva_M
WEST/D7/18bW	03/08/1901	Bayford, Infant_Alice_M
WEST/D7/18c	10/06/1917	Livermore, Maria_H
WEST/D7/18c	25/04/1922	Livermore, James
WEST/D7/18d	05/07/1938	Livermore, Infant_Barbara_J
WEST/D7/19	07/10/1893	Livermore, Sarah_G
WEST/D7/19	22/06/1900	Robinson, Emma
WEST/D7/19a	31/12/1924	Gull, Samuel
WEST/D7/19b	16/05/1925	Griggs, Nathan
WEST/D7/19b	24/02/1937	Griggs, Alice_A_S
WEST/D7/19f	16/08/1926	Chapman, Robert_H

### Sorted by recorded Last Name

<b>Grave</b>	<b>Recorded Date of Interment</b>	<b>Recorded Name</b>
EAST/C5/18a	10/10/1885	Abrahams, Thomas
EAST/F3/8a	30/06/1922	Adam, Constance_N
EAST/D3/8	27/09/1878	Adams, Joseph
WEST/C4/39E	05/01/1870	Adcock, Infant_Mary
WEST/C5/45	02/12/1880	Akers, Alfred
EAST/E3/19E	19/06/1882	Almond, Infant_Walter
WEST/C6/18a	03/01/1906	Amey, Mary_Ann
WEST/C6/18a	11/10/1922	Amey, William
EAST/E2/21	30/01/1882	Ansell, James
EAST/B7/15	08/03/1856	Archer, Emily
WEST/B5/5a	16/08/1912	Archer, Fanny
EAST/C7/12E	12/07/1862	Archer, Infant_Elizabeth
EAST/B7/15	05/03/1888	Archer, Martha

<b>Grave</b>	<b>Recorded Date of Interment</b>	<b>Recorded Name</b>
WEST/B4/8	18/02/1888	Archer, Mary_Ann
EAST/D3/38E	19/09/1873	Archer, Stillborn_of
EAST/D3/2W	24/10/1879	Archer, Stillborn_twins_of
EAST/B7/19	13/12/1856	Archer, Thomas
WEST/B4/6b	21/10/1944	Ash, Infant_Peter
EAST/E2/6	17/11/1883	Ashton, Stillborn_of
WEST/B5/7a	07/10/1948	Ashwell, Infant_Penelope_J
WEST/B3/1a	18/04/1928	Atkin, Rebecca
WEST/B2/13	08/05/1916	Atkin, Richard
EAST/C6/14a	26/02/1915	Ayley, Anne
EAST/C6/14a	23/06/1909	Ayley, David
WEST/B5/3b	21/12/1933	Ayliffe, Infant_Kathleen
WEST/C3/5W	12/04/1879	Bacon, Infant_Florence_E
WEST/C7/12	21/08/1918	Baillie, Elizabeth
WEST/C5/50W	09/03/1875	Baker, Infant_William_J_P
EAST/D4/14a	15/05/1882	Ballard, Sarah
EAST/D4/14a	23/05/1882	Ballard, Stillborn_of
EAST/D4/6	22/12/1869	Banks, Charlotte
EAST/D4/1	23/12/1869	Banks, Joseph
EAST/C5/12	06/10/1863	Barber, James
EAST/C5/8	16/12/1857	Barber, Mary
WEST/C6/7E	02/03/1876	Bardell, Infant_of_William
WEST/C6/6W	24/09/1878	Bardwell, Infant_John
WEST/C4/33	07/11/1873	Barker, Emily
WEST/C6/8W	08/08/1864	Barker, Infant_Alfred_J
WEST/C4/25	04/06/1870	Barrance, John
WEST/C4/29	22/03/1867	Barrance, Rebecca
WEST/D6/7	31/10/1873	Barron, Hannah
EAST/E2/28	27/02/1915	Barron, Harriet
EAST/E2/6	08/09/1883	Barrow, Charles
EAST/D5/9a	04/03/1947	Barton, Infant_Leonard
WEST/C6/15W	10/11/1879	Bass, Infant_Henry_G
EAST/C5/17	12/12/1861	Bates, Mary
EAST/F2/4	26/03/1858	Bates, William
WEST/D7/18bW	03/08/1901	Bayford, Infant_Alice_M
EAST/D2/15W	04/06/1881	Bayford, Infant_Martha
WEST/C6/19	06/05/1893	Bayford, Mary_Ann
WEST/C6/4a	12/12/1887	Beard, Aun
WEST/C6/4a	15/08/1917	Beard, Benjamin
WEST/C5/42	21/11/1883	Beard, Ellen
WEST/C5/42	16/08/1862	Beard, Infant_Walter_N
WEST/C5/47	16/08/1878	Beard, John
WEST/C5/47	30/08/1889	Beard, Susanna
WEST/C6/4b	09/08/1944	Belsham, Infant_Rosemary_R

<b>Grave</b>	<b>Recorded Date of Interment</b>	<b>Recorded Name</b>
WEST/B5/3b	14/11/1942	Benbow, Infant_Frederick_E
WEST/C3/18a	07/09/1930	Bent, Infant_Michael_R
WEST/D6/5	29/06/1875	Billings, Thomas
EAST/E3/7	29/08/1878	Birch, Rebecca
EAST/D3/43	19/12/1871	Biscoe, Samuel
WEST/D6/8	09/10/1872	Blackaby, Joseph
WEST/D6/8	19/10/1889	Blackaby, Sarah
EAST/B7/8	19/01/1856	Blackwell, James
EAST/D4/4	04/08/1869	Blackwell, Stephen
EAST/D4/22b	12/07/1907	Blake, Caroline
EAST/D4/22b	26/03/1891	Blake, Daniel
EAST/C7/6W	13/01/1888	Blake, Infant_Elizabeth
EAST/E3/37b	01/07/1887	Blatch, Thomas
EAST/B6/12E	07/02/1857	Bond, Stillborn_of_Annie
EAST/E2/24a	10/10/1931	Bonney, Infant_Jack_A
WEST/C6/20b	17/06/1940	Bonney, Infant_June
WEST/D7/17E	04/02/1863	Bowfell, Infant_Sarah_A
EAST/D4/5E	10/05/1870	Bowker, Infant_Arthur_V
EAST/D4/5W	03/09/1860	Bowker, Infant_Edward_W
EAST/E3/39	04/09/1877	Bowker, John_B
WEST/C6/18	27/10/1881	Boyten, Ann
EAST/C6/28	30/12/1947	Boyten, Infant_John_R
WEST/C7/9b	08/03/1940	Boyten, Infant_Kenneth
WEST/D5/6a	16/11/1885	Boyten, William
WEST/C5/15	26/05/1876	Boyton, Emma
WEST/C4/12	06/06/1870	Boyton, Henry
WEST/C4/16	15/12/1866	Boyton, John
WEST/C4/20	13/05/1871	Boyton, John
WEST/C4/15	30/04/1864	Boyton, Milly
EAST/C4/16	18/02/1868	Brace, James
EAST/C5/11	25/11/1862	Brace, Mary
WEST/C4/35	11/09/1873	Bradd, Helen_A
WEST/C4/34	06/05/1873	Bradd, Mary
EAST/C6/4	17/03/1858	Bradford, John
EAST/C5/27	04/04/1860	Bradford, Thomas
EAST/F3/10a	21/03/1925	Brazier, Arthur_R
EAST/F3/10a	10/07/1947	Brazier, Elizabeth
EAST/F2/4a	04/03/1905	Brazier, Emma_L
EAST/D2/2a	06/08/1928	Brazier, Florence
EAST/F2/8W	19/10/1901	Brazier, Infant_Constance_A
EAST/F2/4a	07/12/1898	Brazier, Robert
EAST/D3/33	10/07/1873	Brenchley, David
EAST/D2/16	04/02/1941	Brett, Amos
EAST/D2/16	31/01/1936	Brett, Mary_A

<b>Grave</b>	<b>Recorded Date of Interment</b>	<b>Recorded Name</b>
WEST/D5/12a	04/07/1928	Brewster, John
WEST/D5/12a	28/03/1930	Brewster, Martha
EAST/D3/32	14/12/1871	Bright, Mary
EAST/F3/10E	30/06/1885	Britton, Stillborn_Edward
WEST/C5/46	02/03/1891	Brooks, Annie
WEST/C4/1W	25/02/1859	Brooks, Infant_Elizabeth
EAST/C6/7E	10/12/1857	Brooks, Infant_son_of_Mary
WEST/C5/10	24/07/1880	Brooks, Margaret
WEST/C5/46	25/07/1894	Brooks, Thomas
EAST/E2/42	25/11/1887	Brown, Ann
EAST/B6/9W	05/04/1859	Brown, Infant_Charles
EAST/C6/13E	23/01/1858	Brown, Infant_Elizabeth
EAST/D4/17W	17/07/1869	Brown, Infant_Emily
EAST/C6/16	27/01/1863	Brown, John
EAST/D2/3	08/03/1895	Brown, John
EAST/C5/19	20/10/1880	Brown, Mary
EAST/C5/26W	19/02/1866	Brown, Stillborn_of
EAST/D4/20	19/09/1868	Brown, Thomas
EAST/E3/4	14/07/1877	Brown, Thomas
EAST/D5/4b	26/10/1912	Bugg, William
WEST/C5/49	17/12/1879	Bull, George
WEST/C5/38W	31/01/1865	Bull, Infant_Henry
WEST/C5/43W	21/12/1866	Bull, Infant_Henry
EAST/D2/18	14/04/1881	Bull, John
WEST/C5/48	30/12/1871	Bull, John
WEST/D7/12a	07/01/1893	Bull, Mary
WEST/C6/2	07/09/1872	Bull, Mary_E
WEST/B4/15	31/03/1863	Bull, Sarah_A
EAST/D3/14	21/02/1873	Bull, William
EAST/F3/5	08/10/1859	Burder, William_W
WEST/C5/11	11/07/1871	Burls, Joseph
WEST/C5/16	20/09/1870	Burls, Stephen_J_R
WEST/C6/4W	25/01/1870	Burrell, Infant_Ann_Elizabeth
WEST/C6/3	21/02/1876	Burrell, Thomas
WEST/C5/40	07/08/1871	Burton, Sarah
EAST/D3/12	04/08/1878	Bush, Ann
EAST/E2/29W	09/07/1880	Bush, Infant_Ellen
EAST/C6/13W	29/01/1858	Bush, Infant_Emily
WEST/C6/10E	03/03/1877	Bush, Infant_John
WEST/C6/6E	25/04/1879	Bush, Infant_Sydney
EAST/D3/21	18/01/1872	Bush, Infant_William
WEST/B4/9	23/01/1863	Bush, Sarah
WEST/B3/5a	12/02/1925	Bushwell-Wye, Infant_Irene_D
EAST/B6/10W	27/12/1856	Candy, Infant_Elizabeth

<b>Grave</b>	<b>Recorded Date of Interment</b>	<b>Recorded Name</b>
EAST/C5/31	09/11/1864	Candy, Richard
EAST/C5/28	21/04/1866	Candy, Thomas
WEST/D7/1E	30/01/1884	Cannon, Infant_Annie_M
WEST/D7/5W	11/06/1879	Cannon, Infant_Eleanor
WEST/D7/1E	06/04/1881	Cannon, Infant_Emma
WEST/D7/1W	06/04/1881	Cannon, Infant_Emma
WEST/D7/9W	09/06/1883	Cannon, Infant_Minnie
WEST/C7/1b	28/11/1884	Cannon, Milly
WEST/C7/21	28/11/1884	Cannon, Milly
WEST/C4/41	28/06/1865	Careless, Infant_Jane
WEST/C4/41	28/06/1865	Careless, Infant_Joseph
WEST/C5/5W	25/02/1870	Careless, Infant_Sarah_Elizabeth
EAST/E3/18	13/07/1878	Carter, Alfred
WEST/B5/1a	23/04/1910	Carter, Amy
EAST/C6/7W	05/12/1857	Carter, Infant_Sarah
WEST/B5/1a	21/10/1944	Carter, Joseph
EAST/F3/11E	24/12/1884	Carter, Stillborn_of
EAST/C6/19	22/05/1857	Carter, William
EAST/E2/17	20/05/1882	Cass, Charles
EAST/B7/8	12/03/1888	Cass, Elizabeth
EAST/C6/3E	13/01/1858	Cass, Stillborn_of
EAST/B7/24W	08/01/1856	Castle, Stillborn_of_Walter
EAST/E4/30	08/09/1907	Castle, Susanna
WEST/C5/4	02/11/1874	Challis, Hannah_M
WEST/C5/5E	19/01/1876	Challis, Infant_Frank_M
WEST/C5/9	30/05/1873	Challis, James
WEST/C5/14	19/01/1875	Challis, James
EAST/C6/18E	20/06/1862	Chambers, Infant_Henry
EAST/B6/12W	20/12/1856	Chambers, Infant_William_H
EAST/E2/2	26/03/1884	Champness, Elizabeth
EAST/C6/15	04/05/1857	Champness, Francis
EAST/C6/18W	23/01/1863	Champness, Infant_Emma
EAST/C6/20W	12/02/1863	Champness, Infant_Mary
EAST/C6/20E	12/02/1863	Champness, Infant_Millicent
EAST/B7/13	23/02/1856	Champness, Mary
EAST/D4/17W	06/02/1877	Champness, Stillborn_(Hg)_of
EAST/E3/37a	17/09/1886	Chapman, Ann
EAST/D4/10W	12/03/1877	Chapman, Infant_Eliza
EAST/D3/26	15/11/1871	Chapman, James
WEST/D7/19f	16/08/1926	Chapman, Robert_H
EAST/C4/6	16/10/1878	Chapman, Sophia
EAST/D4/13	19/12/1870	Chapman, William
WEST/C3/15W	23/09/1875	Chappell, Infant_Albert
WEST/C3/11E	02/02/1874	Chappell, Infant_Flora_D

<b>Grave</b>	<b>Recorded Date of Interment</b>	<b>Recorded Name</b>
WEST/B3/15W	15/06/1869	Chappell, Infant_Frederick_J
WEST/C3/13E	09/07/1871	Chappell, Infant_Kate_A
WEST/B3/14	29/07/1862	Chappell, Samuel
WEST/C3/15E	13/04/1872	Chappell, Stillborn_of
WEST/B2/14	16/03/1918	Chappell, William
WEST/C3/17W	07/12/1874	Chapple, Infant_Edith
WEST/C4/21W	17/02/1877	Chopping, Bessie
WEST/C4/39W	23/12/1876	Chopping, Infant_Pamela
WEST/C5/33E	14/09/1878	Chopping, Infant_Percy_R
WEST/C5/23E	14/09/1871	Chopping, Infant_Stanton_G
WEST/C6/17W	25/08/1880	Chopping, Infant_Walter
WEST/B4/7	09/06/1885	Clark, Elizabeth
EAST/F2/5	17/02/1915	Clark, Harriet
WEST/C2/18b	13/06/1927	Clark, Infant_Albert_C
WEST/C2/18c	27/01/1932	Clark, Infant_Doris
WEST/C4/19	17/11/1868	Clark, James
WEST/B4/10	23/01/1863	Clark, John_C
EAST/B7/2W	28/12/1855	Clark, Stillborn_of_Frederick
EAST/D3/39E	08/02/1875	Clark, Stillborn_twins_of
WEST/C5/19	27/10/1873	Clarke, James
EAST/D2/12	12/10/1881	Clarke, John
EAST/C4/19	08/05/1857	Clarke, Richard
EAST/C6/14W	20/06/1863	Clauboy, Infant_William
WEST/C4/10a	04/07/1926	Clayden, Infant_Dorothy_J
WEST/C4/14a	01/08/1924	Clayden, Infant_Ernest
WEST/C6/17E	11/08/1884	Clayden, Infant_William_H
WEST/C4/40	06/12/1875	Clayden, James
WEST/C4/32	29/05/1866	Clayton, Jane
EAST/C5/14E	10/11/1888	Coe, Infant_Florence
EAST/E2/14	01/12/1882	Collins, Charles_J
EAST/D3/31E	27/12/1871	Collins, Stillborn_of
EAST/B7/28W	20/02/1856	Collis, Infant_Ann
EAST/D5/10a	20/11/1914	Compton, Sarah
WEST/B5/5a	28/04/1938	Cook, Infant_Arthur_J
EAST/F2/10	09/09/1876	Cook, Sarah_M
EAST/E4/5b	10/01/1935	Cook, Susan_F
EAST/F2/11W	13/10/1880	Cooke, Infant_Harriet_R
EAST/F3/3W	27/11/1875	Coote, Infant_Alice
EAST/F3/3E	28/02/1872	Coote, Infant_Florence_E
EAST/F3/2E	12/10/1870	Coote, Infant_John
EAST/B7/3	26/11/1855	Coote, Infant_Lucy
EAST/F3/2W	11/08/1868	Coote, Infant_Thomas_J
WEST/B3/27a	27/12/1902	Cornell, Ann
WEST/B3/28	06/02/1885	Cornwell, Ann

<b>Grave</b>	<b>Recorded Date of Interment</b>	<b>Recorded Name</b>
WEST/B4/22	22/09/1876	Cornwell, Penelope
WEST/B3/28	02/10/1865	Cornwell, William
WEST/D6/2	13/11/1886	Cowell, Eliza_A
EAST/B6/6W	21/08/1857	Cowell, Infant_Selina
EAST/B6/10E	05/05/1857	Cox, Stillborn_male_of
EAST/C5/22	27/01/1862	Coxall, Ann
EAST/C5/24	10/06/1858	Coxall, Edward
EAST/B7/29E	29/05/1856	Coxall, Infant_Emma
EAST/B7/29W	29/05/1856	Coxall, Infant_Emma
EAST/C5/18	11/02/1863	Coxall, Sarah
EAST/E3/24W	22/12/1880	Crabb, Infant_Emma_E
EAST/D4/27W	02/02/1869	Crabb, Infant_Martha
WEST/C4/17	18/01/1875	Cracknell, Frederick_G
WEST/C6/20	02/10/1891	Cracknell, George
WEST/C6/20	02/04/1922	Cracknell, Harriet
WEST/B3/1W	21/08/1858	Cracknell, Infant_Edward
WEST/C4/7W	02/12/1862	Cracknell, Infant_Joseph
WEST/C4/1E	13/10/1864	Cracknell, Stillborn_of
WEST/D7/9E	02/12/1910	Crisp, Infant_Bertram
WEST/D7/13a	09/05/1925	Crisp, Infant_Kathleen_M
EAST/D3/44	26/01/1875	Curtis, Ann
WEST/B4/15b	30/12/1919	Curtis, Infant_Leonard_W
WEST/B3/6	27/08/1862	Dalton, Charles
WEST/B5/10c	26/02/1913	Dawling, Harriet
EAST/D2/23W	29/06/1888	Day, Infant_girl_of
WEST/B5/6	30/12/1859	Death, Gideon
EAST/F3/18b	15/02/1923	Deller, Infant_Cecil_C
WEST/C6/22	26/06/1885	Dellow, David
EAST/E4/21W	12/06/1865	Dellow, Infant_Kate
EAST/D4/16	12/05/1866	Dench, Edward
EAST/D4/19	02/11/1861	Dench, Joseph
EAST/B7/30W	12/11/1856	Dixon, Infant_Thomas
WEST/B2/9	09/10/1860	Dixon, Joseph
WEST/B4/4a	23/09/1939	Dorman, Infant_Jean
EAST/C7/6E	15/05/1863	Dorrington, Infant_Emma
EAST/C7/8	12/07/1862	Dorrington, James
EAST/B6/8E	05/06/1857	Dorrington, Stillborn_of_Mary
EAST/E2/5	12/04/1883	Downes, Samuel
WEST/C3/1a	31/01/1917	Drage, Sarah_A
EAST/F3/16a	25/10/1927	Drake, Infant_Elizabeth_A
WEST/D6/18	26/01/1887	Dunnage, Annie_L
EAST/B7/34	19/11/1856	Dunnage, George
EAST/F3/6b	19/04/1915	Dutnall, Infant_Robert_V
EAST/E3/29	18/10/1879	Dyson, Harriet

<b>Grave</b>	<b>Recorded Date of Interment</b>	<b>Recorded Name</b>
EAST/E2/18E	03/06/1882	Eaton, Infant_Elizabeth
WEST/B3/17a	02/12/1927	Edwards, Infant_Charles
EAST/C7/15W	16/05/1862	Edwards, Infant_Eliza
EAST/C7/6W	02/05/1864	Edwards, Infant_Elizabeth
WEST/C3/8W	16/08/1894	Ellis, Infant_Roland_F
WEST/C2/26	06/12/1902	Ellis, Sarah_K
EAST/B6/13W	10/09/1856	Ellison, Infant_Mary_Isabella
EAST/D4/8	19/05/1871	Erswell, Ann
WEST/C3/2a	17/02/1941	Everett, Emma
WEST/C3/4a	02/04/1928	Everett, George
WEST/C3/2a	24/02/1925	Everett, Jane
WEST/C3/22W	21/01/1867	Faircloth, Infant_Louisa_A
EAST/F3/22b	17/07/1917	Fanner, Infant_Florence_M
EAST/E3/2	13/01/1879	Felsted, Jane
WEST/B4/25W	27/06/1863	Feltham, Infant_Frederick_Francis
WEST/C4/18E	05/04/1882	Filby, Infant_Agnes_M
EAST/F2/4c	09/05/1949	Finch, Infant_Michael
EAST/B7/20E	16/02/1857	Finch, Stillborn_of
WEST/D7/13E	30/04/1912	Firman, Infant_Cyril
EAST/B7/6	18/12/1855	Fish, Catherine
EAST/C7/15E	09/07/1862	Fish, Infant_Henry
EAST/D2/9	20/01/1882	Fisher, Rachel
EAST/C7/15W	07/02/1885	Fiske, Stillborn_of
WEST/C6/17b	21/11/1906	Fitch, Elizabeth
EAST/E2/29W	20/05/1880	Fitch, Infant_James
WEST/C6/17b	03/05/1915	Fitch, Robert
EAST/D3/9E	10/01/1877	Flack, Infant_John
EAST/C5/30	01/03/1858	Flack, Maria
EAST/E2/26E	28/04/1882	Flack, Stillborn_of
EAST/E3/17	27/12/1876	Fleury, Elizabeth
EAST/C5/2	23/03/1946	Fordham, Albert_J
EAST/B7/9	04/01/1856	Fordham, Catherine
EAST/C5/5	16/09/1938	Fordham, Charlotte
EAST/C5/25a	01/03/1901	Fordham, Charlotte
EAST/C6/2W	26/03/1859	Fordham, Infant_Mary_Ann
EAST/C5/15a	21/06/1884	Fordham, James
EAST/C5/25a	04/09/1914	Fordham, James_W_J
EAST/C5/2	27/01/1933	Fordham, Mabel_M
EAST/C5/15a	05/01/1893	Fordham, Martha
WEST/C3/2a	11/10/1926	Fordham, Rosetta
WEST/B5/3a	06/04/1910	Francis, Caroline
EAST/E2/8	29/12/1915	Francis, Elizabeth
EAST/E2/30	27/01/1881	Francis, Thomas
EAST/D2/10	05/05/1932	Francis, William

<b>Grave</b>	<b>Recorded Date of Interment</b>	<b>Recorded Name</b>
WEST/D6/4b	28/02/1925	Free, George
EAST/E3/10	14/08/1868	Freeman, Ann
EAST/E3/5	19/04/1871	Freeman, John
WEST/C6/13a	20/07/1917	Fuller, Bertie_T
EAST/C5/21W	25/11/1882	Fuller, Infant_Alfred
EAST/C5/16W	03/01/1885	Fuller, Infant_John
EAST/C5/21W	09/02/1888	Fuller, Infant_of
EAST/C5/14W	16/12/1882	Fuller, Infant_William
WEST/C3/16E	14/12/1866	Fuller, Infant_William
WEST/D7/13b	13/07/1940	Fuller, Sarah
EAST/C5/21W	09/12/1887	Fuller, Stillborn_of
WEST/C6/7a	14/07/1919	Fuller, Wallis_R
WEST/D7/13b	10/12/1927	Fuller, William_J
EAST/E4/29	21/04/1906	Gates, Caroline
EAST/E3/40	11/01/1875	Gates, George
WEST/B3/27a	19/09/1891	Gibbs, Elizabeth
EAST/D2/6	19/02/1923	Gilbey, Annie
EAST/E4/7a	26/10/1896	Gilbey, Emma
EAST/E2/7	19/01/1892	Gilbey, George
EAST/E3/32	27/11/1875	Gilbey, Stephen
EAST/E4/7a	15/04/1885	Gilbey, Thomas
WEST/D6/28	13/06/1901	Gillett, Edmund
WEST/D6/28	29/01/1898	Gillett, Elizabeth
WEST/D6/25	15/12/1880	Gillett, Linda
WEST/D6/26	08/06/1875	Gillett, William
EAST/D3/11	09/12/1874	Ginn, Edward
EAST/B7/5	15/01/1856	Glasscock, James
WEST/B4/6	21/02/1862	Glasscock, James
WEST/B4/3	26/01/1861	Glasscock, Sarah
EAST/C6/14E	07/05/1862	Goats, Infant_Sarah
EAST/C5/25	12/12/1861	Goodson, Emily
WEST/B3/24	05/09/1860	Gould, James
WEST/C4/13	28/05/1873	Gould, Mary
WEST/C4/9	25/11/1874	Gould, Samuel
WEST/C7/2c	18/06/1923	Grant, Infant_George
WEST/D6/20	21/10/1890	Gray, Emma
EAST/D3/30E	15/04/1874	Gray, Infant_David
EAST/D2/23E	13/03/1888	Gray, Infant_of
EAST/B6/14	15/09/1856	Greata, William
WEST/D7/4a	06/11/1915	Green, Alfred
WEST/D7/17a	10/08/1921	Green, Annie
WEST/C3/11W	11/05/1876	Green, Infant_Ann
WEST/D6/20aW	04/01/1903	Green, Infant_Doris_A
WEST/D6/20aW	10/03/1894	Green, Infant_Edith_J

<b>Grave</b>	<b>Recorded Date of Interment</b>	<b>Recorded Name</b>
WEST/D6/20aE	07/04/1894	Green, Infant_Eleanor
EAST/F2/13E	03/11/1913	Green, Infant_Frederick_J
WEST/B2/10E	25/08/1866	Green, Infant_Henry
WEST/D7/8a	12/05/1904	Green, Mary
WEST/C5/5W	17/04/1929	Gregory, Mary_A
WEST/D6/23	24/10/1877	Grey, John
EAST/E2/13	13/09/1882	Griffen, Mary
WEST/D7/19b	24/02/1937	Griggs, Alice_A_S
EAST/D3/41	29/12/1870	Griggs, Charles
WEST/D5/2E	18/04/1861	Griggs, Infant_Arthur_W
WEST/D5/5W	08/04/1861	Griggs, Infant_Herbert_J
WEST/D5/4E	22/05/1857	Griggs, Infant_of_
EAST/E3/19E	13/12/1880	Griggs, Infant_Thomas_H
WEST/D7/19b	16/05/1925	Griggs, Nathan
EAST/E2/9	13/10/1882	Guiver, William
WEST/C5/2	03/02/1869	Gull, George
WEST/D7/14	15/01/1886	Gull, Hannah
WEST/C4/37W	19/01/1867	Gull, Infant_Martha
WEST/C6/7W	12/07/1875	Gull, Infant_Nathan
WEST/C5/1W	21/08/1868	Gull, Infant_Susannah
WEST/D7/7	11/11/1874	Gull, Ruth
WEST/D7/19a	31/12/1924	Gull, Samuel
WEST/D7/18	16/08/1892	Gull, Sarah_E
EAST/E3/24W	03/09/1886	Haines, Infant_William_C
WEST/C4/11	21/05/1863	Hales, Benjamin
EAST/E3/14E	13/10/1879	Halestrap, Stillborn_of_S
EAST/F2/2a	17/10/1893	Halls, William
EAST/E3/39a	25/10/1890	Hammond, John
WEST/D7/6	19/04/1875	Hanchett, Thomas
EAST/F2/8a	21/08/1917	Handscomb, Albert
WEST/C5/39W	03/03/1881	Handscomb, Infant_Harriet
WEST/C5/23W	14/03/1867	Handscomb, Infant_Martha
EAST/F2/8a	15/03/1929	Handscomb, Mary_Ann
EAST/E2/25W	31/07/1882	Handscomb, Stillborn_of
EAST/F2/4b	15/06/1905	Handscomb, Violet_M
WEST/C5/34	20/02/1880	Handscomb, William
WEST/C5/18W	01/12/1871	Handscombe, Infant_Charles
WEST/C5/33W	29/08/1878	Handscombe, Infant_Eliza
WEST/C5/34	20/12/1884	Handscombe, Infant_Fanny
WEST/C4/10	02/04/1909	Handscombe, John
WEST/C5/13	25/03/1872	Handscombe, Rebecca
EAST/D3/40	15/03/1871	Harding, John
EAST/B7/2E	02/01/1856	Harle, Stillborn_of
EAST/E2/28a	30/03/1915	Harmsworth, Charles

<b>Grave</b>	<b>Recorded Date of Interment</b>	<b>Recorded Name</b>
EAST/F2/2	09/06/1921	Harrington, Arthur_H
EAST/F2/3a	30/08/1907	Harrington, Mary_Ann
EAST/F2/3a	24/04/1906	Harrington, William_H
EAST/D5/1a	05/03/1905	Harris, Elizabeth
WEST/D6/15	20/12/1876	Harris, John
EAST/D5/1a	21/02/1882	Harris, William
EAST/D3/6W	14/09/1892	Harrison, Infant_Lily
EAST/B6/5W	06/10/1857	Hart, Infant_of
WEST/D6/6	08/05/1888	Hart, Stillborn_of
WEST/C3/1	03/05/1902	Harvey, Emma
WEST/C2/22	11/06/1937	Harvey, Emma_G
WEST/B3/4W	15/04/1862	Harvey, Infant_Ernest_John
WEST/B2/12	10/10/1872	Harvey, Infant_Frederick_E
WEST/C3/1	11/02/1900	Harvey, James
WEST/C3/1	23/11/1889	Harvey, James_H
WEST/D7/2	13/10/1883	Hauchett, Elizabeth
EAST/F2/1a	01/07/1915	Hawkes, Thomas
WEST/B4/1a	18/01/1916	Haynes, Infant_Mabel
EAST/D2/11	09/07/1881	Heard, Dan
WEST/C4/21E	13/09/1871	Hendry, Infant_Norman_W
EAST/E3/21	06/04/1876	Hennifer, Richard
WEST/C4/30	27/05/1875	Hibbard, John
WEST/C7/13	24/12/1926	Hicks, Walter_J
EAST/E2/36W	16/01/1881	Hills, Infant_Eliza_E
EAST/E2/29E	22/07/1880	Hills, Infant_Martha
WEST/C6/17a	19/02/1913	Hoare, Celiah
WEST/C5/31	14/06/1882	Hollidge, Charlotte
WEST/C5/26E	27/04/1893	Hollidge, Infant_Fred_M
WEST/C5/21E	19/06/1893	Hollidge, Infant_Nellie_C
WEST/B5/8b	26/10/1918	Hollidge, Kate_V
WEST/C6/11a	15/04/1944	Hopson, Infant_Samuel
WEST/C4/6a	26/10/1914	Hopwood, John
EAST/E3/1	29/12/1879	Howard, Winifred
EAST/B7/25	06/05/1856	Howlett, Charles
WEST/C2/9b	18/01/1933	Hughes, Clara
WEST/B4/20	28/04/1880	Hughes, Emily
WEST/C2/9b	12/09/1944	Hughes, Frank_M
WEST/B4/20	29/09/1877	Hughes, James
WEST/D6/19	05/11/1884	Hutchin, Elizabeth
WEST/C6/27E	26/04/1880	Hutchin, Infant_George
WEST/D6/27E	26/04/1880	Hutchin, Infant_George
WEST/D6/22W	15/09/1880	Hutchin, Infant_Mary_Ann
WEST/D6/17a	19/02/1904	Hutchin, Maria
WEST/C3/7a	04/06/1931	Hutchin, Minnie

<b>Grave</b>	<b>Recorded Date of Interment</b>	<b>Recorded Name</b>
EAST/C6/8a	29/09/1904	Hutchins, Eliza
EAST/B6/11E	23/12/1856	Hyde, Infant_Eliza_Jane
WEST/C6/1a	29/07/1911	Ingold, Ann
WEST/C6/1a	03/06/1899	Ingold, George
WEST/C4/23	10/02/1864	Ingold, John
WEST/C5/41	08/01/1890	Ingold, Sarah
WEST/C4/28E	05/06/1869	Ingold, Stillborn_of
EAST/D2/7	01/05/1882	Ingram, George
WEST/D7/18a	24/02/1928	Jackson, Emily_H
WEST/B3/21a	14/03/1932	Jackson, Infant_William_D
EAST/E3/35	12/04/1875	Jackson, Mary_Ann
WEST/C4/24	08/02/1867	Jackson, Sarah
WEST/D7/18a	25/04/1925	Jackson, William
EAST/D5/14b	09/10/1947	Jarvis, Infant_Rita
EAST/C6/10	22/05/1860	Jeffreys, Jeffery
EAST/C5/23a	04/10/1888	Johnson, Sarah_Ann
EAST/E3/19E	08/07/1882	Joscelyne, Stillborn_of
WEST/C2/18a	13/06/1922	Jubb, Joseph_G
EAST/B7/29E	25/08/1856	Judd, Infant_Henry
EAST/C5/29W	17/09/1864	Judd, Infant_Sarah_A
EAST/D3/35	20/09/1871	Judd, John
EAST/D4/20a	04/11/1881	Judd, Mary_Ann
EAST/D4/2	29/08/1870	Judd, Peter
EAST/E3/39b	04/02/1907	Judd, Peter
EAST/C6/12a	11/07/1907	Judd, Sarah
EAST/D3/29	20/03/1875	Judd, William
EAST/D3/24W	01/11/1875	Jugby, Infant_Thomas_A
EAST/E3/20	18/12/1875	Keane, Ann
EAST/F3/18W	15/05/1909	Keeler, Infant_Frederick_J
EAST/E2/20	25/09/1915	Keeler, Infant_Herbert_J
WEST/C6/15a	14/12/1918	Kelly, Beatrice_E
WEST/B4/12	13/06/1860	Kelly, Elizabeth
EAST/D3/42	27/11/1871	Kent, George
EAST/B7/26	10/09/1856	Kent, William_S
EAST/E2/41E	20/07/1882	King, Infant_Elizabeth
EAST/E2/41E	10/12/1883	King, Infant_William
EAST/C6/12	05/02/1883	King, Stillborn_of
EAST/C5/7	07/03/1872	King, William
EAST/C7/10	09/02/1863	Kinsey, Ann
EAST/C7/20	07/05/1886	Kinsey, Emma
EAST/C7/13	20/06/1857	Kinsey, George
EAST/C7/16	03/11/1869	Kinsey, Jeremiah
EAST/C7/20	15/12/1882	Kinsey, Mary_Ann
EAST/B7/22	04/08/1856	Kinsie, Esther

<b>Grave</b>	<b>Recorded Date of Interment</b>	<b>Recorded Name</b>
EAST/C7/14	13/06/1862	Kinzie, Emma
EAST/C4/4	19/10/1878	Kitchener, Charlotte
EAST/D4/24E	18/06/1862	Kitchener, Infant_Martha
EAST/F3/15a	20/12/1921	Kitchener, Infant_Thomas_G
EAST/D4/24W	05/03/1862	Kitchener, Infant_William
EAST/D4/12	05/02/1867	Kitchener, Martha
EAST/D4/7	10/10/1870	Kitchener, William
EAST/D4/17a	02/07/1881	Kitchener, William
WEST/C6/22a	06/12/1915	Knight, Arthur
EAST/C6/4a	02/11/1881	Knight, Eliza
WEST/D6/4a	31/12/1930	Knight, Eliza
WEST/C6/22a	14/12/1940	Knight, Emily_A
EAST/C6/5W	15/01/1858	Knight, Infant_Emily_J
EAST/D4/18W	31/12/1865	Knight, Infant_John
EAST/C4/10	01/05/1875	Knight, James
EAST/C6/6a	14/09/1892	Knight, Joshua
WEST/B4/13	29/11/1859	Knight, Sarah
EAST/B6/5E	20/10/1884	Knight, Stillborn_of
EAST/B6/9E	22/06/1859	Knight, Stillborn_of
EAST/C4/8W	18/02/1878	Knight, Stillborn_of_William
EAST/C6/6a	06/08/1881	Knight, Thomas
EAST/D4/15	06/02/1861	Knight, William
EAST/F3/6	06/09/1922	Knott, Emma
EAST/B7/27E	04/04/1857	Lacey, Infant_female_of
WEST/D6/11	24/06/1943	Lambert, Florence_J
WEST/D6/11	05/05/1915	Lambert, Henry_E
EAST/B7/7W	11/04/1856	Lambert, Infant_Ellen
EAST/B7/28E	10/03/1856	Lambert, Infant_Sarah
EAST/F3/18E	06/02/1909	Langdon, Infant_Esther_E
WEST/B3/31	05/10/1861	Lankester, Mary_B
WEST/C2/25a	30/11/1925	Lavell, Infant_Frederick_H
EAST/F2/1	15/10/1914	Lawrence, Emily
EAST/F2/3	17/02/1881	Lawrence, George
WEST/D7/10E	08/11/1878	Lawrence, Stillborn_of
EAST/B7/10E	18/03/1856	Leech, Stillborn_of
EAST/B7/30E	12/11/1856	Lestrangle, Infant_Robert_J
WEST/C5/21W	01/06/1870	Lilley, Infant_Arthur_S
WEST/C6/14W	30/08/1880	Lilley, Infant_William_J
WEST/C6/19b	30/08/1922	Lilley, James
EAST/E3/41	24/03/1884	Lilley, John
WEST/C6/19b	11/09/1912	Lilley, Margaret
EAST/E3/27	22/05/1876	Lilley, Sarah
EAST/B7/31	17/02/1857	Lilley, Susannah
WEST/C6/14W	06/01/1882	Lilly, Infant_Ernest

<b>Grave</b>	<b>Recorded Date of Interment</b>	<b>Recorded Name</b>
EAST/B7/17	13/02/1856	Lincoln, David
WEST/D7/5E	02/07/1879	Linsell, Stillborn_of
WEST/D7/12a	21/09/1898	Livermore, Daniel
WEST/D7/11	28/10/1874	Livermore, Elizabeth
WEST/D7/18d	05/07/1938	Livermore, Infant_Barbara_J
WEST/D7/16aW	20/08/1912	Livermore, Infant_Charles
WEST/D7/16W	08/12/1885	Livermore, Infant_Charles
WEST/D7/10W	02/06/1876	Livermore, Infant_Daniel
WEST/B3/9a	01/09/1926	Livermore, Infant_Horace_E
WEST/D7/18c	25/04/1922	Livermore, James
WEST/D7/18c	10/06/1917	Livermore, Maria_H
WEST/D7/15	19/10/1887	Livermore, Mary_Ann
WEST/D7/19	07/10/1893	Livermore, Sarah_G
WEST/D7/13W	17/11/1881	Livermore, Stillborn_of
WEST/D7/8E	01/08/1876	Livermore, Stillborn_of_William
WEST/D7/8W	14/04/1877	Livermore, Stillborn_of_William
WEST/D7/15	21/12/1925	Livermore, Thomas
EAST/F3/13a	09/09/1949	Livings, Infant_Paul_D
WEST/B4/22a	10/02/1925	Lobb, Infant_Daisy
WEST/B4/22a	10/12/1925	Lobb, Infant_Violet
WEST/B5/10	14/07/1875	Lock, Catherine_M
WEST/B5/10	21/12/1867	Lock, Infant_Amelia_E
WEST/B5/10	10/04/1867	Lock, Infant_Thomas_B
EAST/D2/5W	09/05/1882	Loveday, Infant_Charles
WEST/B4/7a	02/03/1941	Lovell, Infant_David_S
EAST/C6/27	10/12/1912	Lucking, Annie
EAST/D4/20b	05/03/1911	Lucking, Infant_Mary
EAST/E2/26W	01/06/1881	Manning, Stillborn_of
EAST/D3/10	18/06/1874	Marshall, Nathaniel
EAST/B7/16	19/03/1879	Marshall, Sarah
EAST/B7/23	16/12/1856	Marshall, Thomas
EAST/E3/42	24/08/1912	Marshall, William
WEST/B5/10b	05/03/1909	Martin, Charles
EAST/D2/14	01/06/1881	Martin, Charles_H
WEST/B5/10a	24/07/1931	Martin, Edward
WEST/B5/10b	19/09/1924	Martin, Eliza
WEST/C5/31	22/02/1884	Martin, Elizabeth
WEST/B5/10a	03/10/1927	Martin, Lizzie
WEST/C3/9b	02/04/1947	Martin, Sarah
WEST/C3/9b	08/05/1933	Martin, William
EAST/D2/20	27/07/1880	Matthews, Catherine_A
EAST/E3/6	23/08/1879	Matthews, David
EAST/B7/35	21/02/1857	Matthews, Elizabeth
EAST/C7/17	21/02/1857	Matthews, Elizabeth

<b>Grave</b>	<b>Recorded Date of Interment</b>	<b>Recorded Name</b>
EAST/C7/17	26/03/1857	Matthews, James
EAST/D3/16	17/02/1872	Matthews, Mary_Ann
WEST/C4/8	06/12/1869	Mears, Hannah
WEST/C5/35E	12/08/1869	Merritt, Infant_John
EAST/E3/23W	28/02/1887	Miles, Infant_Bertie_T
EAST/E3/23W	07/02/1877	Miles, Infant_Mary_Ann
WEST/C3/10	13/01/1875	Miller, Ann
WEST/C3/13W	04/09/1877	Miller, Infant_Beatrice_A
WEST/C3/8E	20/06/1874	Miller, Infant_Ellen_E
WEST/C3/8E	05/09/1870	Miller, Infant_Herbert_W
EAST/E2/36E	10/06/1885	Miller, Infant_Margaret
EAST/D2/1a	01/09/1931	Miller, Infant_Peter_J
EAST/C6/7E	28/11/1887	Miller, Infant_Robert
WEST/B3/16	01/11/1865	Miller, Mary_Ann
WEST/C3/9	31/07/1875	Miller, Samuel
EAST/F3/9W	31/12/1863	Miller, Stillborn_of
WEST/D6/3	21/08/1877	Milton, John
EAST/D3/24E	28/07/1875	Milton, Stillborn_twins_of
WEST/B2/4	12/04/1914	Mitchell, George
EAST/F3/12E	05/08/1885	Mitchell, Infant_Emma_M
WEST/D5/3a	25/07/1947	Mitchell, Infant_John
WEST/B2/4	18/04/1933	Mitchell, Mary_A
EAST/D3/37	01/12/1871	Moffart, Mary
WEST/C3/15b	22/08/1949	Mole, Infant_Pamela_A
WEST/C2/15b	31/10/1932	Monk, Infant_Carol_M
EAST/D4/18aE	12/08/1909	Monk, Infant_Dennis_W
EAST/C5/21E	14/04/1863	Morris, Infant_John
EAST/E2/31	13/11/1886	Morton, Samuel
WEST/B4/26a	04/01/1918	Mott, Louisa
WEST/C5/33E	14/09/1878	Moyes, Stillborn_of
EAST/F3/13W	07/02/1885	Mumford, Infant_Edwin_J
EAST/C5/6	29/06/1932	Murrell, Edith_B
WEST/B4/23W	19/03/1861	Myson, Infant_John
WEST/D7/3	01/07/1874	Nash, Elizabeth
EAST/B7/18	14/05/1856	Nash, Millie
WEST/C6/16W	29/04/1882	Neville, Infant_Ada_M
WEST/C6/15E	16/04/1880	Neville, Infant_Edward_W
EAST/D5/2a	28/02/1900	Newman, Alfred
WEST/B3/13	24/07/1863	Newman, Elizabeth
WEST/B4/1	11/01/1866	Newman, Emma
WEST/D5/7b	30/01/1911	Newman, Emma
WEST/C3/12W	06/12/1878	Newman, Infant_Annie
WEST/B3/11E	04/03/1864	Newman, Infant_Edward_T
EAST/F3/8W	02/02/1861	Newman, Infant_Henry

<b>Grave</b>	<b>Recorded Date of Interment</b>	<b>Recorded Name</b>
WEST/B4/13a	02/07/1931	Newman, Infant_Pauline_D
WEST/C3/12E	12/09/1873	Newman, Infant_Rose_A
EAST/F3/8E	10/08/1863	Newman, Infant_William
WEST/C3/14	10/11/1869	Newman, Jeffery
EAST/D5/3a	18/11/1902	Newman, John
WEST/B4/4	20/11/1868	Newman, John
WEST/B4/15a	30/03/1935	Newman, Margaret
EAST/C7/5	26/06/1857	Newman, Mary
WEST/B3/34a	20/11/1928	Newman, Mary_Ann
EAST/D4/27a	03/11/1882	Newman, Philip
EAST/D2/21	21/08/1880	Newman, Thomas
WEST/B3/34a	29/11/1915	Newman, Thomas
WEST/B4/20a	03/04/1922	Newman, Walter
EAST/B6/3	22/12/1877	Newman, William
EAST/D5/2a	07/08/1884	Newman, William
WEST/B3/17	30/06/1858	Newman, William
WEST/B3/34	24/11/1865	Newman, William
WEST/B4/15a	18/09/1916	Newman, William
WEST/B3/24a	10/04/1886	Nicholls, Eliza
EAST/D3/18	12/05/1874	Nicholls, William
WEST/C6/1	03/12/1878	Nind, Elizabeth
WEST/C3/2a	07/04/1927	Nutter, Margaret_M
EAST/F3/14b	11/12/1925	Oliver, Infant_Annie_D
EAST/C4/13	01/03/1872	Orger, Martha
EAST/F2/7	25/04/1928	Osborne, Infant_Kenneth
EAST/E2/36E	30/07/1885	Osborne, Infant_of
EAST/D3/36	20/04/1871	Page, Edward
EAST/E2/18E	28/03/1883	Palmer, Stillborn_of
WEST/B4/24	01/01/1910	Parish, John
WEST/B4/24	17/07/1913	Parish, Rachel
EAST/E2/32	19/07/1912	Parker, Eliza
WEST/B3/7	25/07/1928	Parker, George
EAST/D4/24a	12/03/1883	Parker, Hannah
WEST/B2/7	02/10/1945	Parker, Harriet
WEST/B3/2E	11/06/1859	Parker, Infant_Elizabeth
EAST/D4/11	07/01/1872	Parker, Infant_Emily
WEST/B3/3E	30/05/1863	Parker, Infant_Robert
EAST/E3/25	24/10/1879	Parker, John
WEST/B2/3	18/11/1874	Parker, Mary_Ann
WEST/B3/7	01/07/1863	Parker, Robert
WEST/B3/8	01/04/1867	Parker, Robert
WEST/C3/24a	18/10/1928	Parker, Sarah_E
WEST/B3/8	16/09/1892	Parker, Sophia
WEST/B3/1E	17/12/1858	Parker, Stillborn_of

<b>Grave</b>	<b>Recorded Date of Interment</b>	<b>Recorded Name</b>
WEST/C3/24a	24/10/1944	Parker, Walter_G
WEST/C6/5	24/01/1903	Parkin, Emma
WEST/C6/11	17/06/1913	Parkin, Samuel
WEST/C6/5	16/03/1912	Parkin, William
EAST/C5/9	05/07/1932	Pateman, Charles
WEST/D6/6	16/04/1888	Pateman, Esther
EAST/C5/9	28/03/1929	Pateman, Harriett_D
EAST/D4/18E	03/10/1871	Pateman, Infant_Edith
WEST/C6/10W	25/09/1876	Pateman, Infant_George
EAST/B6/6E	10/09/1857	Pateman, Infant_Mary_Ann
EAST/B6/4W	16/09/1862	Pateman, Infant_Sarah
WEST/D6/4W	19/06/1882	Pateman, Infant_William_J
WEST/C6/18b	02/02/1910	Pateman, James
WEST/D7/15a	07/07/1893	Pateman, Joseph
WEST/C6/18b	18/12/1920	Pateman, Sarah
WEST/D6/9	23/06/1884	Pateman, William
EAST/B7/4W	23/08/1859	Patmore, Stillborn_of
EAST/F3/3a	15/05/1908	Patrick, Elizabeth_L
WEST/C5/6W	23/06/1869	Pavitt, Infant_Matilda_E
WEST/C5/26W	24/06/1863	Paxman, Infant_Hyrum
EAST/E2/4	04/08/1916	Payne, Infant_Charles
EAST/D3/31W	20/12/1871	Payne, Infant_Gertrude_M
EAST/B6/11W	06/12/1856	Peachey, Stillborn_of
WEST/B5/4	05/01/1889	Peacock, Anne
WEST/C5/1E	01/09/1863	Peacock, Infant_Mary_E
WEST/B4/25E	20/09/1861	Peacock, Infant_William_J
WEST/B2/5	15/12/1915	Peacock, Maria
WEST/B5/2	13/02/1861	Peacock, Samuel
WEST/C5/6E	21/03/1870	Peacock, Stillborn_of
WEST/C3/11x	17/09/1931	Pearman, Minnie
WEST/C5/32	06/01/1879	Perkin, Alice
WEST/C5/37W	29/08/1876	Perkins, Infant_Emma
EAST/D5/6b	14/06/1947	Perkins, Infant_Thomas_C
EAST/E3/37	06/01/1883	Perry, George
EAST/E2/34	15/05/1880	Perry, Harriet
EAST/D4/10E	17/03/1877	Perry, Infant_Thomas_H
EAST/E3/37	29/06/1869	Perry, Mary
WEST/C7/24	21/12/1929	Perry, Mary_A
EAST/C6/3W	31/12/1857	Perry, Stillborn_of
WEST/C5/18E	09/06/1875	Phillips, Infant_Mary_Ann
WEST/B4/2	26/07/1860	Phipp, Caroline
WEST/D5/18	23/01/1891	Phipp, Henry
WEST/C3/16W	21/06/1870	Phipp, Infant_Alfred_H
WEST/C4/7E	26/03/1877	Phipp, Infant_John_W

<b>Grave</b>	<b>Recorded Date of Interment</b>	<b>Recorded Name</b>
WEST/C3/17E	16/09/1873	Phipp, Infant_Thomas_H
WEST/D5/18	27/01/1891	Phipp, Susan
WEST/B3/32	12/09/1863	Phipp, Thomas
WEST/B2/1	27/02/1918	Pickess, Jabez
WEST/B2/1	09/04/1914	Pickess, Sarah
WEST/D5/8	27/04/1918	Pigram, Elizabeth
WEST/D5/8	06/01/1882	Pigram, Margaret
WEST/D6/12	23/07/1887	Piper, Charles
WEST/C5/35W	24/04/1869	Piper, Infant_Walter
WEST/C5/30	13/03/1866	Piper, Israel
EAST/D2/6c	18/04/1940	Piper, Mary_A
EAST/D2/4	13/12/1941	Piper, Sarah_A
EAST/C6/5E	12/04/1858	Piper, Stillborn_of
EAST/D2/4	29/07/1927	Piper, William
EAST/D3/22W	29/03/1873	Player, Infant_Annie
EAST/E3/3W	23/03/1888	Player, Infant_Florence_M
WEST/D5/44	07/06/1875	Player, Sarah
WEST/B4/10a	09/06/1920	Pomphrett, Infant_kathleen_I
EAST/E3/15	03/12/1875	Poole, Emma
EAST/D2/17W	07/11/1891	Pope, Infant_Agnes_E
EAST/D2/15E	31/08/1889	Pope, Infant_Alice_E
EAST/E3/22	23/06/1876	Pope, John
EAST/E4/26	19/06/1882	Pope, Louisa
EAST/E3/36	04/09/1873	Pope, William
WEST/B2/15	14/05/1940	Porter, Infant_Percy
WEST/C2/26	28/05/1880	Portway, Charles
WEST/B3/12	15/12/1881	Portway, Peter
WEST/B3/12	02/05/1903	Portway, Sarah
WEST/C4/37E	06/06/1863	Portway, Stillborn_of
WEST/B2/8	02/07/1873	Portway, William
WEST/C2/26	03/02/1909	Postway, Sarah
WEST/B3/23E	14/03/1862	Potter, Infant_Eliza_Emily
WEST/B3/22	03/09/1860	Potter, Joseph
WEST/B3/30a	13/05/1892	Potter, Sarah
WEST/B3/30a	27/09/1902	Potter, William
WEST/D6/17E	15/12/1888	Pound, Infant_Ethel
WEST/B4/17	20/10/1862	Prance, Sarah
WEST/C7/4a	19/06/1940	Prime, Infant_Geoffrey_H
WEST/C6/12	16/02/1880	Prior, Agnes_L
EAST/C6/6	06/04/1859	Prior, Ann
EAST/D5/10a	15/06/1925	Prior, Ann
WEST/B3/18	25/12/1858	Prior, Benjamin
EAST/D4/9	19/10/1870	Prior, Charles
EAST/B7/32	13/03/1856	Prior, Daniel

<b>Grave</b>	<b>Recorded Date of Interment</b>	<b>Recorded Name</b>
WEST/D5/14	21/10/1876	Prior, Elizabeth
WEST/C3/22W	21/03/1870	Prior, Infant_Alfred
EAST/D3/39W	08/02/1875	Prior, Infant_Emily
EAST/D4/27E	01/04/1863	Prior, Infant_Fanny
WEST/C6/9E	12/07/1881	Prior, Infant_Frank
WEST/C6/9W	28/01/1880	Prior, Infant_Frederick
WEST/C6/4E	19/07/1872	Prior, Infant_George
WEST/C5/50E	21/02/1873	Prior, Infant_Richard
WEST/C3/23	05/05/1876	Prior, Joseph
EAST/C4/3	08/11/1880	Prior, Mary
WEST/D5/14a	15/09/1923	Prior, Mary
WEST/D6/21	20/06/1883	Prior, Richard
WEST/C5/37E	31/08/1877	Prior, Stillborn_of_Fred
WEST/B3/19	03/10/1863	Prior, Thomas
WEST/D5/14a	16/07/1930	Prior, Walter
EAST/D3/22E	31/05/1873	Privett, Stillborn_twins_of
WEST/B4/23E	07/03/1862	Pryer, Infant_Thomas
EAST/D3/28	24/01/1874	Quant, John
EAST/D3/23	14/02/1874	Quilter, Benjamin
EAST/C7/19	25/03/1857	Quinlan, Catherine
EAST/D4/3	17/11/1871	Rand, William
EAST/C6/13W	04/02/1888	Ratcliff, Infant_Alfred
EAST/D3/7	25/10/1879	Read, Ann
EAST/E3/23E	09/12/1878	Read, Infant_George
EAST/F2/9	24/02/1915	Reed, Emma
EAST/D2/19W	23/03/1888	Reed, Infant_Elsie_E
EAST/D3/2W	31/10/1885	Reed, Infant_Elsie_M
EAST/F3/3b	23/10/1913	Reed, Infant_Ephraim_L
EAST/F2/4b	21/01/1914	Reed, Infant_Florence_M
EAST/C5/14W	18/05/1899	Reed, Infant_Henry
EAST/D4/14W	07/09/1867	Reed, Infant_James
EAST/C5/14W	28/02/1890	Reed, Infant_Mary_Ann
EAST/F3/11E	24/10/1884	Reed, Infant_Matilda
WEST/B5/10c	03/04/1933	Reed, Infant_Norma_P
EAST/E4/27aE	05/05/1909	Reed, Infant_William
EAST/C5/23W	08/10/1900	Reed, Infant_William_A
EAST/E2/25E	09/02/1882	Reed, Stillborn_of
EAST/D3/3	08/05/1880	Reed, Thomas
EAST/F2/9	16/07/1930	Reed, William
EAST/D4/22b	16/06/1930	Rickett, Elizabeth
WEST/B3/27	04/12/1867	Rickett, Elizabeth
EAST/D4/26	05/01/1866	Rickett, Ellen
WEST/C4/5	01/03/1873	Rickett, George
EAST/C7/12W	30/01/1863	Rickett, Infant_Emily

<b>Grave</b>	<b>Recorded Date of Interment</b>	<b>Recorded Name</b>
EAST/D4/26a	13/03/1885	Rickett, Jaems
WEST/B3/36	31/05/1860	Rickett, Maria
EAST/D4/23	19/04/1864	Rickett, William
WEST/B3/33	20/07/1864	Ricketts, John
EAST/D4/25	10/01/1859	Ricketts, Sarah
EAST/C5/8	07/04/1888	Ridgley, Mary
WEST/C7/24	31/08/1918	Roberts, Florence_A
EAST/C5/4	29/11/1862	Roberts, William
WEST/C7/14	25/01/1929	Robinson, Amelia
WEST/D7/19	22/06/1900	Robinson, Emma
EAST/C5/21a	21/06/1884	Robinson, Stillborn_of
EAST/E2/25E	04/09/1880	Robinson, Stillborn_of
EAST/B7/16	29/11/1856	Rumball, Infant_Joseph
EAST/D2/8	22/05/1923	Rumble, Annie
EAST/B6/13E	13/09/1856	Rumble, Infant_Elizabeth_Ann
EAST/E3/24E	24/11/1880	Rumble, Infant_George
EAST/B7/20W	01/03/1856	Rumble, Infant_James
EAST/B6/8W	01/06/1857	Rumble, Stillborn_of_Mary
EAST/E2/22	09/12/1881	Rumble, William
WEST/B5/46a	08/01/1944	Russo, Infant_Keith_R
EAST/E2/16	05/12/1915	Saddler, Elizabeth
WEST/C5/7	21/08/1866	Saggs, George
WEST/D6/6a	02/05/1927	Saich, Emma
WEST/D6/6a	13/04/1927	Saich, Henry
WEST/D6/22E	09/05/1884	Saich, Infant_Henry_J
WEST/D6/27W	03/04/1879	Saich, Stillborn_of
WEST/D5/12	04/05/1881	Salmon, Harriett
WEST/B4/16	02/03/1861	Salmon, Henry
WEST/C4/14	28/07/1904	Salmon, Henry
WEST/C4/22E	25/03/1880	Salmon, Infant_Benjamin
WEST/B4/18W	11/05/1861	Salmon, Infant_Eliza
WEST/C4/4	21/12/1866	Salmon, Matilda
WEST/B4/11	23/02/1859	Salmon, Nathaniel
WEST/B4/14	05/04/1860	Salmon, Robert
WEST/C5/29	02/03/1875	Salmon, Thomas
WEST/C4/4	26/08/1908	Salmon, William
EAST/D4/28a	01/11/1883	Saltmarsh, Charlotte
EAST/D4/28	10/04/1858	Saltmarsh, Samuel
EAST/C6/20E	12/01/1888	Sampford, Infant_Rose
EAST/E2/27	18/08/1887	Sapsford, Alice
EAST/E3/28	02/06/1874	Sapsford, Cornelius
EAST/E2/1W	14/08/1885	Sapsford, Infant_Alice
WEST/B3/20E	04/09/1872	Sapsford, Infant_Percy_J
EAST/E2/26W	20/08/1887	Sapsford, Infant_William

<b>Grave</b>	<b>Recorded Date of Interment</b>	<b>Recorded Name</b>
WEST/B3/15E	15/01/1868	Sapsford, Infant_Willie_D
WEST/B3/26	13/09/1870	Sapsford, James
EAST/E3/34	14/01/1881	Sapsford, Mary
WEST/C3/15a	03/10/1939	Sapsford, Mary_M
EAST/B7/11	02/02/1856	Sapsford, Sarah
WEST/B3/26	30/10/1878	Sapsford, Sarah
WEST/B3/20W	24/07/1876	Sapsford, Stillborn_of_George
WEST/C3/15a	03/04/1948	Sapsford, William
EAST/F2/8E	28/08/1913	Savage, Infant_Winifred_M
EAST/D3/15	02/06/1874	Savage, John
WEST/D6/16	22/02/1876	Say, Eleanor_G
WEST/D6/13W	21/01/1870	Say, Infant_Joseph_G
WEST/D6/14	10/05/1899	Say, John
WEST/D6/14	12/02/1895	Say, Rebecca
WEST/D6/10W	30/01/1871	Say, Stillborn_of
WEST/D6/10E	01/10/1872	Say, Stillborn_of_John
WEST/B3/25	16/10/1860	Scarfe, Infant_Herbert_J
WEST/B4/18E	27/07/1887	Scherzinger, Infant_George_L_W_L
EAST/E2/26E	01/06/1881	Seamark, Infant_Emily
WEST/C5/28	27/10/1877	Searle, Alfred
EAST/E3/8	19/03/1879	Searle, Michael
WEST/C5/28	26/10/1900	Searle, Sarah
EAST/D2/3a	02/07/1928	Sell, John_J
EAST/D4/24b	09/11/1911	Seuell, Infant_William
WEST/B5/4b	22/02/1916	Sewell, Infant_Annie
EAST/E3/14W	07/05/1879	Sewell, Infant_Ellen
EAST/F3/11W	02/01/1885	Sewell, Infant_George
EAST/E3/19W	05/04/1880	Sewell, Stillborn_of
EAST/E2/10	10/03/1883	Shaw, Elizabeth
EAST/E2/15	29/06/1891	Shed, Mary
EAST/D4/22	28/08/1866	Shed, John
EAST/E3/26	03/03/1876	Shedd, Henry
EAST/D4/21	12/10/1860	Shedd, Maria
WEST/B2/2	27/11/1914	Shepherd, Alice_E
WEST/B4/21	24/05/1861	Sherman, Sarah_D
WEST/C7/2b	24/02/1912	Shorter, Arthur
EAST/B7/27W	11/02/1857	Shorter, Infant_Alfred
EAST/B7/14	20/12/1884	Shorter, Susan
EAST/B7/14	11/02/1856	Shorter, William
EAST/B7/33	05/06/1856	Simons, Susan
WEST/B4/18a	29/07/1938	Simpson, Infant_John_A
WEST/D7/18bE	27/02/1909	Skinner, Infant_Eva_M
WEST/B4/8	21/09/1859	Smith, Charles
WEST/B4/5	16/03/1861	Smith, Elizabeth

<b>Grave</b>	<b>Recorded Date of Interment</b>	<b>Recorded Name</b>
EAST/C6/1W	15/12/1857	Smith, Infant_Charles
EAST/F3/17E	12/11/1908	Smith, Infant_Fred
WEST/B3/24b	08/01/1939	Smith, Infant_Michael_C
EAST/C6/2E	10/08/1860	Smith, Infant_Nathan
WEST/C7/6a	17/01/1938	Smith, Infant_Pamela_P
EAST/C6/12	05/02/1883	Smith, James
EAST/E4/3b	25/01/1912	Smith, James
EAST/E2/39	09/02/1880	Smith, Jane
EAST/E3/38	18/12/1875	Smith, Mary
EAST/D4/11	07/01/1872	Smith, Mary_Ann
EAST/C6/12	11/07/1871	Smith, William
EAST/D3/27	30/01/1872	Snow, Allan
EAST/F2/6	23/02/1915	Snowden, Infant_Robert_C
EAST/F3/4	27/04/1864	Soole, Charlotte
EAST/E3/14W	19/06/1878	Soole, Infant_Walter
EAST/F3/1	31/07/1868	Soole, John
EAST/F3/7	09/04/1860	Soole, Samuel
EAST/F2/13W	23/11/1909	Spencer, Infant_John_H_T
WEST/D6/17W	05/05/1863	Spooner, Infant_Sydney_H
EAST/C6/20W	08/09/1887	Stracey, Infant_Abraham
EAST/D2/6a	07/03/1934	Stringer, Annie
EAST/D2/6a	28/09/1944	Stringer, James_R
EAST/C5/20	28/10/1859	Stubbings, Sarah
WEST/C2/17a	28/10/1924	Sullivan, Ada
EAST/C5/6	14/04/1943	Sutton, Ellen
EAST/B7/24E	07/02/1856	Tattingham, Infant_Ellen
EAST/F3/13E	28/02/1885	Tattingham, Infant_Emma
WEST/D6/22E	09/05/1884	Tattingham, Stillborn_of
WEST/B3/13a	02/09/1926	Taylor, Infant_Cyril
EAST/B6/2E	30/08/1880	Taylor, Infant_Ernest
WEST/C3/24	14/12/1877	Tharby, Esther
WEST/B3/5	10/07/1860	Tharby, Henry
WEST/B3/9	10/06/1859	Tharby, Malachia
EAST/C4/15	20/02/1890	Thickings, Ann
WEST/C3/20	02/04/1872	Thickings, Sarah_A
EAST/D2/15E	23/02/1882	Thickings, Stillborn_of
WEST/C3/18	12/05/1911	Thorne, John
WEST/C5/39E	22/10/1884	Thornton, Infant_Amy
EAST/C4/14	25/10/1933	Threadgold, Charlotte
EAST/C6/2b	27/08/1904	Threadgold, Rebecca
EAST/C5/24a	07/09/1904	Threadgold, William
EAST/C6/2b	12/09/1911	Threadgold, Zachariah
WEST/D7/12	20/08/1868	Threadgold, Zachariah
WEST/B2/3	04/08/1931	Thresher, Infant_Kenneth_B

<b>Grave</b>	<b>Recorded Date of Interment</b>	<b>Recorded Name</b>
WEST/C4/27	28/11/1868	Thurgood, Ephraim
WEST/B2/6W	05/03/1873	Thurgood, Infant_Clara_H
WEST/B3/23W	22/05/1962	Thurgood, Infant_Elizabeth_A
WEST/B3/2W	08/04/1859	Thurgood, Infant_James
WEST/B2/10W	26/04/1867	Thurgood, Infant_Mercy
EAST/F3/26a	20/06/1917	Thurgood, Infant_Robert_J
EAST/D3/38W	12/09/1873	Thurgood, Infant_Sarah
WEST/B3/21	16/01/1858	Thurgood, Mary
EAST/D2/1	16/08/1919	Thurgood, Mary_Ann
WEST/B4/19	11/04/1864	Thurgood, Sarah
EAST/D3/34W	26/02/1875	Thurgood, Stillborn_(Wm)_of
EAST/B6/5E	09/10/1857	Thurgood, Stillborn_of
WEST/B2/6E	07/01/1879	Thurgood, Stillborn_of
WEST/B2/11E	08/07/1872	Thurgood, Stillborn_of_John
WEST/C4/3	22/10/1877	Thurgood, Susan
EAST/C6/16a	14/03/1940	Thurley, Frederick_T
EAST/F3/18b	02/10/1923	Thurley, Infant_Reginald_J
WEST/C2/15a	18/08/1924	Thurley, Lydia_E
EAST/C6/16a	19/05/1911	Thurley, Mary_Ann
EAST/D3/17	03/02/1873	Tinworth, George
EAST/E3/11	02/07/1877	Tipler, Susan
WEST/C4/36	23/06/1881	Tisoe, Ann_I
EAST/D4/31E	21/06/1909	Trott, Infant_Edith_M
WEST/B2/11W	26/02/1868	Tucker, Infant_Alfred_W
WEST/B3/3W	08/04/1867	Tucker, Infant_Alfred_W
WEST/B2/7	10/10/1870	Tucker, Sophia
WEST/B2/7	10/10/1870	Tucker, Stillborn_of_Sophia
WEST/C4/38	26/03/1864	Tunnicliff, Eliza
EAST/C5/32	10/11/1902	Turner, Charles
EAST/D3/21	18/01/1872	Turner, Charlotte
EAST/C7/3	11/12/1856	Turner, Eliza
EAST/C7/2	19/01/1867	Turner, Elizabeth
EAST/C5/25b	10/09/1911	Turner, Infant_Charles
EAST/C6/2E	17/08/1886	Turner, Infant_Edward
EAST/B6/4E	06/03/1877	Turner, Infant_Esther
EAST/D4/18aW	08/11/1909	Turner, Infant_Florence_D
EAST/B6/2W	27/08/1880	Turner, Infant_Herbert
EAST/D3/30W	16/10/1871	Turner, Infant_John
EAST/E4/27aW	21/04/1909	Turner, Infant_Violet_I
EAST/C7/4	13/03/1861	Turner, James
WEST/C6/13	14/11/1877	Turner, Lucy
EAST/C5/30	08/10/1885	Turner, Martha
EAST/C6/2a	13/08/1881	Turner, Mary_Ann
EAST/B6/6W	08/10/1883	Turner, Stillborn_of

<b>Grave</b>	<b>Recorded Date of Interment</b>	<b>Recorded Name</b>
EAST/C5/16W	27/02/1885	Turner, Stillborn_of
EAST/E2/41E	04/09/1882	Turner, Stillborn_of
EAST/E3/12W	27/02/1883	Turner, Stillborn_of
EAST/E3/31	23/02/1876	Tyler, Elizabeth
EAST/E3/30	18/01/1879	Tyler, Hannah
EAST/E3/34a	21/10/1881	Tyler, Joseph
EAST/B7/7E	19/10/1860	Tyler, Stillborn_of
EAST/E2/19	24/05/1890	Tyler, William
EAST/B7/12	08/01/1856	Uncle, Caroline
WEST/C5/36	09/04/1889	Uncle, Harriet
EAST/B7/10W	20/02/1856	Uncle, Infant_Charles_W
EAST/D3/19W	19/06/1876	Unknown, Infant
EAST/C6/1E	13/01/1858	Unknown, Infant_of
EAST/C6/11E	05/11/1857	Unknown, Stillborn_of
EAST/D5/18a	16/06/1947	Walker, Infant_Robert
EAST/D4/14E	01/04/1872	Walker, Infant_Walter_J
WEST/C3/21a	15/05/1929	Walker, Infant_William_C
EAST/E2/25W	29/06/1881	Warner, Stillborn_of
EAST/E2/37E	09/02/1898	Warwick, Infant_Archibald
EAST/F3/12a	19/03/1923	Warwick, Infant_Arthur_W
WEST/B4/7b	28/02/1941	Warwick, Infant_Ernest_G
EAST/E3/16	10/07/1876	Warwick, John
WEST/C5/20	12/11/1879	Waterman, David
WEST/C5/25	23/12/1878	Waterman, George
WEST/C4/28W	30/06/1871	Waterman, Infant_Frederick
WEST/C4/18W	19/05/1898	Waterman, Infant_Robert_W
WEST/C5/3	01/01/1875	Waterman, Lydia
WEST/C5/24	01/03/1878	Waterman, Lydia_A
EAST/C7/11	09/01/1858	Waterman, Robert
EAST/B7/21	21/03/1856	Waterman, Susan
EAST/C6/8	29/02/1860	Waterman, William
EAST/C7/9	12/03/1858	Waterman, William
EAST/D4/22a	20/05/1882	Waterworth, Thomas
WEST/B3/11W	30/05/1863	Watson, Infant_Emma
WEST/C3/5E	20/09/1870	Watson, Infant_George
WEST/C3/6	14/07/1875	Watson, Mary_Ann
WEST/C3/3	13/11/1871	Watson, Ruth
EAST/C7/7	08/06/1857	Watson, Sarah
EAST/E3/13	07/12/1878	Webb, Ann
EAST/E2/18W	22/12/1888	Webb, Infant_Charles
WEST/C2/26b	16/02/1925	Webb, Infant_Dorothy_M
EAST/D2/2W	06/11/1882	Webb, Infant_Esther
EAST/D2/2W	19/02/1887	Webb, Infant_George
EAST/E2/1W	30/09/1884	Webb, Infant_Hester

<b>Grave</b>	<b>Recorded Date of Interment</b>	<b>Recorded Name</b>
EAST/E4/1b	29/10/1927	Wellow, Infant_Grace_L
EAST/C6/17	09/09/1857	Wenham, Caleb
WEST/C3/21	16/03/1878	West, Sarah
EAST/C5/21a	21/06/1884	Westwood, William
EAST/E3/9	15/03/1878	Wheeler, John
WEST/C5/8	02/05/1871	Whitby, Charles
WEST/C4/31	06/06/1882	Whitby, Daniel
WEST/D5/10	15/06/1885	Whitby, Honor
WEST/B3/10	20/01/1864	Whitby, Joseph
WEST/B3/10	02/02/1861	Whitby, Mary
WEST/C5/22	25/07/1870	White, Henry
EAST/C5/14E	10/11/1888	White, Infant_Alice_L
EAST/D4/27b	22/10/1910	White, Infant_Charles_E
EAST/D4/20a	04/01/1925	White, Infant_Joan_A_M
EAST/C6/18E	16/09/1887	White, Infant_Maud_D
WEST/C5/12	05/07/1867	White, James
WEST/C5/27	02/03/1872	White, Lizzie
WEST/C5/17	05/01/1867	White, Mary_Ann
WEST/D5/17	13/02/1874	White, Susan
EAST/E3/33	15/03/1873	White, Thomas
EAST/E4/27	15/09/1885	Whitehead, Eliza
WEST/B4/23a	27/07/1939	Wigley, Infant_Margaret_C
WEST/B4/14a	08/01/1944	Wilkins, Infant_Linda_A
EAST/E2/33	20/03/1915	Willey, Alice
EAST/E3/3W	06/09/1878	Willie, Infant_Belinda_J_L
EAST/C5/15	25/01/1859	Willis, Charles
EAST/C4/18	24/11/1877	Willis, James
EAST/D2/8a	23/04/1931	Wilson, Infant_Edith_E
EAST/D3/4E	02/12/1892	Wilson, Infant_James
WEST/D7/4	22/02/1898	Wilson, Susannah
EAST/B6/9W	13/02/1904	Wood, Infant_Gwendoline
EAST/C7/1	24/07/1856	Wood, John
WEST/B3/29	28/07/1863	Woodcock, Ann
WEST/D6/1	23/11/1881	Woodcock, James
WEST/D5/16	26/12/1874	Woodcock, Sarah
EAST/F2/1	26/07/1913	Woodfall, Eliza
EAST/E2/12	06/12/1915	Woodley, Eliza
WEST/C4/6	27/04/1877	Yardley, Amy
EAST/C6/9	26/12/1857	Yardley, Ann
WEST/C3/19	09/11/1866	Yardley, Anne
WEST/C4/2	20/04/1872	Yardley, Hannah
EAST/C6/11W	22/10/1857	Yardley, Infant_Mary_Ann
WEST/B3/30	06/08/1867	Yardley, William

### ***Schedule of owners of Exclusive Rights of Burial that it is proposed be extinguished***

<b>Grave Reference</b>	<b>Recorded Owner of ERB</b>
EAST/C4/9a	Tucker - V_M
EAST/C7/20	Kinsey - Emma
EAST/F2/12	Patrick - Ada_Mary
EAST/F2/2	Harrington - A_Herbert
EAST/F2/3a	Harrington - William_H
EAST/F2/4a	Brazier - Emma_L
EAST/F2/8a	Handscomb - Albert
EAST/F3/10a	Brazier - E
EAST/F3/3a	Patrick - Ada_Mary
EAST/F3/6a	Patrick - Ada_Mary
WEST/B2/2	Sheppard - Alice
WEST/B3/1a	Atkin - Rebecca
WEST/B4/23a	Wigley - Fanny
WEST/B4/7	Clarke - Elizabeth
WEST/B5/10	Lock - Robert
WEST/B5/10a	Martin - Family_of
WEST/B5/7a	Ashwell - Jeffery
WEST/C2/22	Harvey - E_G
WEST/C2/9b	Hughes - F_M
WEST/C3/9b	Martin - S
WEST/C5/41	Ingold - George
WEST/C5/42	Beard - Benjamin_Nind
WEST/C5/47	Beard - Benjamin_Nind
WEST/C6/1	Beard - Benjamin_Nind
WEST/C6/1a	Ingold - Edwin_G
WEST/D7/18a	Jackson - H_S
WEST/D7/19f	Griggs - A_A_S

### ***Schedule of owners of Memorials that it is proposed be removed***

The Council has no record of the owners of memorials on the affected graves. Where the exclusive right of burial is privately owned, the owner of the ERB, which it is presumed is also the owner of the memorial, is listed above.